

12 - 258

DAF

CHASSIS.

1. SOLDER OR GLUE (24) TO CHASSIS (22), GLUE (24B) TO (22) UP AGAINST FINS ON CHASSIS.
2. GLUE (29) TO (22) AND THEN GLUE (28) BETWEEN (24B) AND (29).
3. GLUE IN (23) CUTTING (24) TO LENGTH. GLUE TO CHASSIS (25, 26 AND 27).
4. TYRE AND WHEEL UP REAR AND MID AXLES ON CHASSIS, OFFER BODY TO CHASSIS, LINDING UP WHEELS WITH ARCHES AND DRILL BODY, 2.3mm.
5. DRY FIT CAB TO CHASSIS, MARK AND DRILL FOR (17), STACKS SHOULD BE AT A HEIGHT TO REST ABOVE TOOL BOX (25).

RECOVERY ASSEMBLY.

1. (38 AND 36) TO (37). GLUE (45) TO (36) ACROSS (37). GLUE (40) TO (39).
2. SOLDER OR GLUE (41 AND 42) TO (35) AND GLUE IN (43 AND 44).
3. GLUE IN PARTS (51, 52 AND 53).
4. PAINT ALL PARTS OF RECOVERY MECHANISM AND ASSEMBLE LATER.

BODY.

1. (34) CAN BE CUT TO CORRECT HEIGHT AND FITTED NOW OR FITTED LATER AFTER PAINTING.
2. DRILL BODY TO SUIT WIRE RAIL AND RAIL SUPPORT.
3. GLUE (47 AND 48) TO (46). (59 AND 60) ASSEMBLED LATER.
4. DRY FIT CAB AND BODY TO CHASSIS. TO POSITION (46) CORRECTLY, TOP BAR OF (46) UP AS CLOSE AS POSSIBLE TO STACKS, AND PLACE MECHANISM INTO BODY, LIFT ARM UP TO ENSURE ARM CLEARS (46), (46) MAY NEED RESHAPING TO CLEAR.

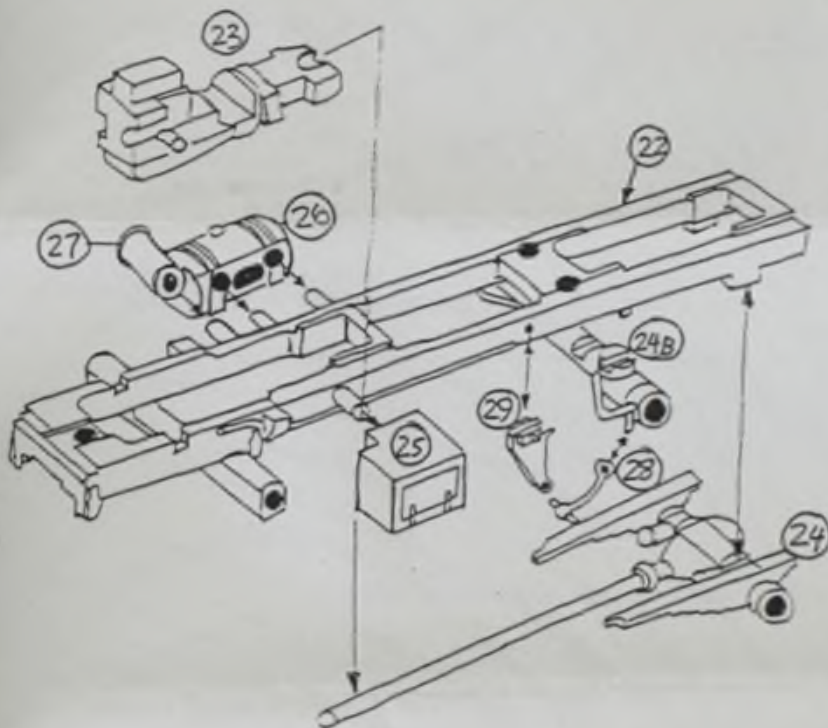

FINAL ASSEMBLY

1. GLAZE CAB. SOLDER OR GLUE IN SEATS, GLUE TO CAB PARTS (31 AND 32) SOLDER OR GLUE (7/8) TO CAB. BEND AND GLUE IN (70).
2. ASSEMBLE MECHANISM.
3. GLUE MECHANISM INTO BODY, ENSURE MECH. ARM CLEARS (46). PAINT ALL SMALL PARTS MIRRORS, LIGHTS ETC.
4. FIT STACK PIPE TO CAB, SCREW CAB TO CHASSIS. SCREW BODY TO CHASSIS. GLUE (59 AND 60) (46).
5. TYRE AND WHEEL UP.

DAF 95 RECOVERY.

- | | | |
|---------------------------|--------------------------|----------------------------------|
| 1. FRONT. | 24. REAR AXLE. | 46. HAZARD LIGHT FRAME. |
| 2. SIDE. | 24B. MID. AXLE. | 47. LONG LIGHT PLATE. |
| 3. SIDE. | 25. TOOL BOX. | 48. SHORT LIGHT PLATE. |
| 4. BACK. | 26. FUEL TANK. | 49. CYLINDERS 2 OFF. |
| 5. ROOF. | 27. AIR TANK. | 50. RAMS 2 OFF. (1.2mm SPLIT PIN |
| 6. VIZOR. | 28. STEERING ROD. | 51. FRAME. |
| 7. BUMPER. | 29. BRACKET. | 52. LIGHT. |
| 8. UNDER SPOILER. | 30. RIVETS (1.5mm) 2 off | 53. ARM SIDE LIGHTS. |
| 9. DASHBOARD. | 31. CAB MUDGUARD. | 54. BRASS ROD (1.2mm). |
| 10. STEERING WHEEL. | 32. " " . | 55. RIVETS 2 OFF (1.2mm). |
| 11. MIRROR. | 33. BODY. | 56. " 2 OFF (1.5mm). |
| 12. MIRROR. | 34. BODY PLATE. | 57. RAIL SUPPORT. 2 OFF. |
| 13. CURB MIRROR. | 35. MAIN FRAME. | 58. RAIL (WIRE .7mm). |
| 14. AIR INTAKE. | 36. ARM PIVOT BLOCK. | 59. HAZARD LIGHTS 2 OFF. |
| 15. HEADLIGHTS 2 OFF. | 37. ARM. | 60. HAZARD LIGHTS 4 OFF. |
| 16. SPOILER LIGHTS 2 OFF. | 38. ARM BRACKET. | 61. SCREWS 3 OFF NO.4 12mm.) |
| 17. STACK PIPE. | 39. FORK PIVOT. | 63. TYRES 9 OFF. |
| 18. SPOTLIGHTS 2 OFF. | 40. LIFTING FORK. | 64. WHEELS FRONT. 5 OFF. |
| 19. ROOF LIGHTS 4 OFF. | 41. LEG BRACKET. | 65. WHEELS REAR 2 OFF. |
| 20. FLOOR. | 42. " " . | 66. BACK PLASTICS 7 OFF. |
| 21. SEATS. | 43. LEG. | 67. SCREEN. |
| 22. CHASSIS. | 44. LEG. | 68. WINDOW PLASTIC. |
| 23. SUMP. | 45. WINCH. | 69. AXLE RODS 3 OFF. |
| | | 70. CAB HAND RAIL (.7mm WIRE). |

TOOLS REQUIRED.

FILES, FLAT (COARSE), ROUND (COARSE), NEEDLE FILES (COARSE). PLIERS, CUTTERS (END). MODELLERS KNIFE, SELECTION OF SMALL DRILLS.

1. CHECK ALL PARTS.
2. DEBURR AND CLEAN UP ALL PARTS.
3. DRILL, (3 AND 2) .7mm TO SUIT (11 & 12). AND 1mm FOR (13). DRILL (9) 1.4mm TO SUIT (10). DRILL (5) TO SUIT (18) 1.2mm AND (19) .8mm. DRILL (37) TO SUIT (30) 1.5mm. (51) AND (52) 1.2mm. DRILL (39) TO SUIT ROD (54) 1.2mm. DRILL (36) TO SUIT RIVETS (55) 1.2mm. DRILL (46) TO SUIT (47 AND 48) 1.5mm.
4. SOLDER, EPOXY RESIN, OR SUPER GLUE MAY BE USED.
5. WHEN USING SUPER GLUE, CARE IS NEEDED SO AS TO STOP WHITENING OF WINDOW PLASTIC TO STOP THIS, PLACE MODEL IN FRONT OF WARM AIR BLOWER, (BUT NOT TO CLOSE), A HAIRDRIER IS IDEAL.

NOTE. DRY FIT SCREEN AND SIDE WINDOW BEFORE ASSEMBLY.

CAB ASSEMBLY.

1. SOLDER OR GLUE (1,2,3 AND 4). GLUE ON (5). GLUE TO ROOF AND SIDES PARTS (11,12,13,18 AND 19). GLUE (6) TO (5).
2. GLUE (21) ONTO (20), DRY FIT INTO CAB BE FORE PAINTING.
3. GLUE (10) TO (9), GLUE (7) TO (8) THESE PARTS CAN BE POLISHED OR SILVER PAINTED.
4. (17) CAN BE POLISHED OR PAINTED SILVER. PARTS (31 AND 32) TO BE PAINTED SAME COLOUR AS CAB WHEEL ARCH AND FITTED TO CAB AFTER SEATS HAVE BEEN FITTED.
5. PAINT PARTS (10/9),(20/21),(15),(16),(14) AND FIT ON FINAL ASSEMBLY.
6. MARK AND DRILL SIDES FOR (70), .7mm WIRE. FIT CAB HAND RAIL LATER.

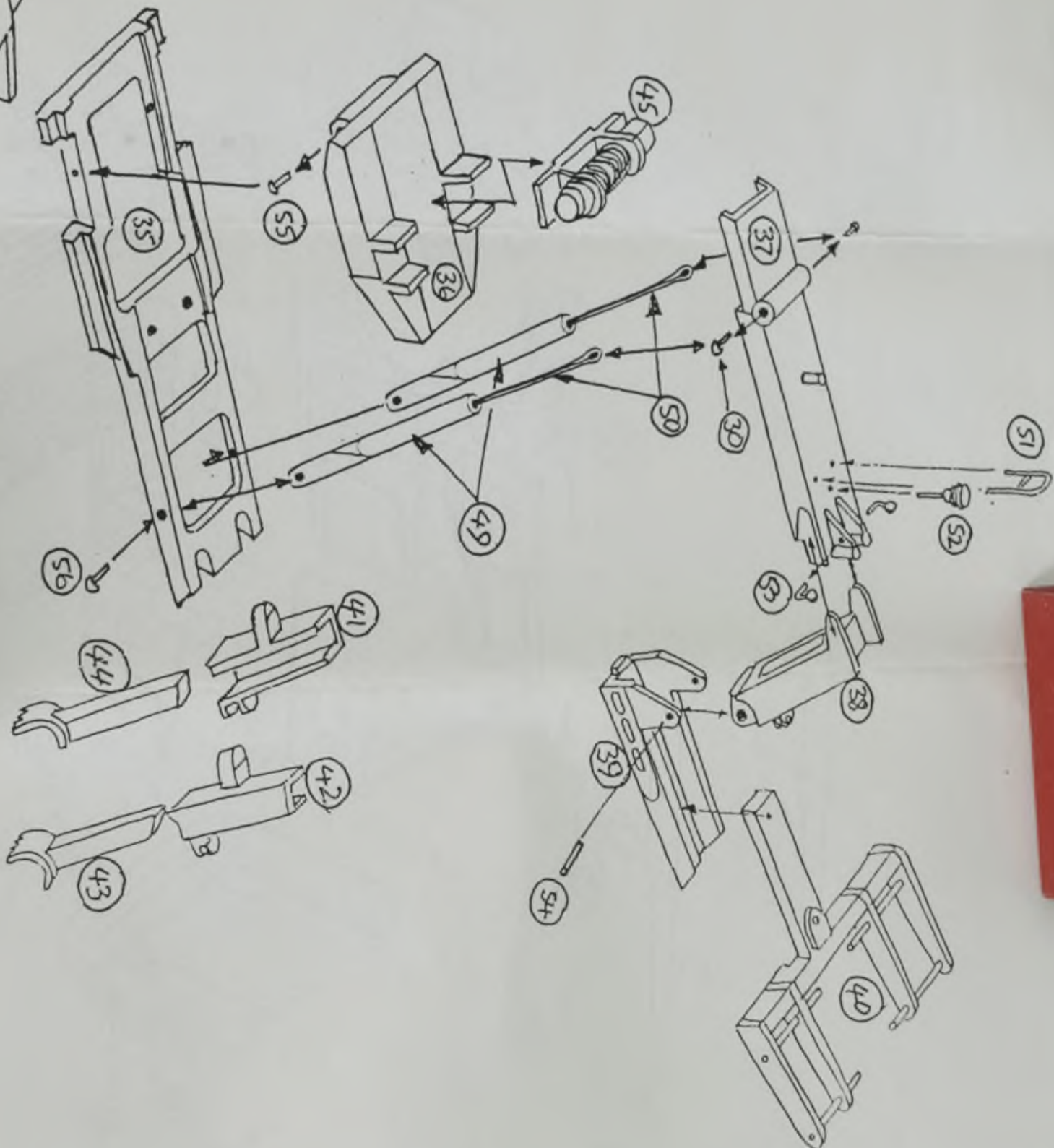
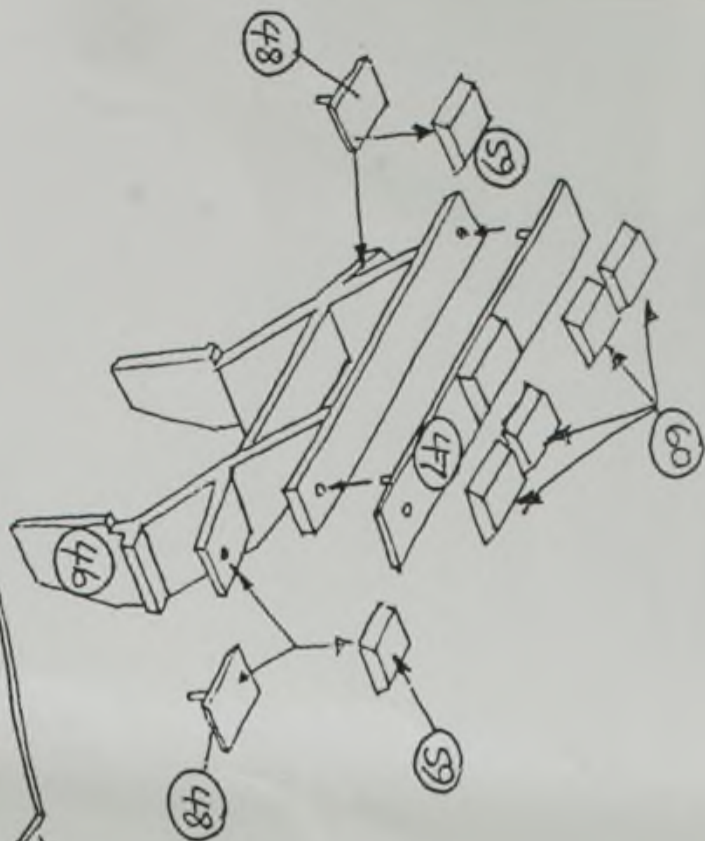
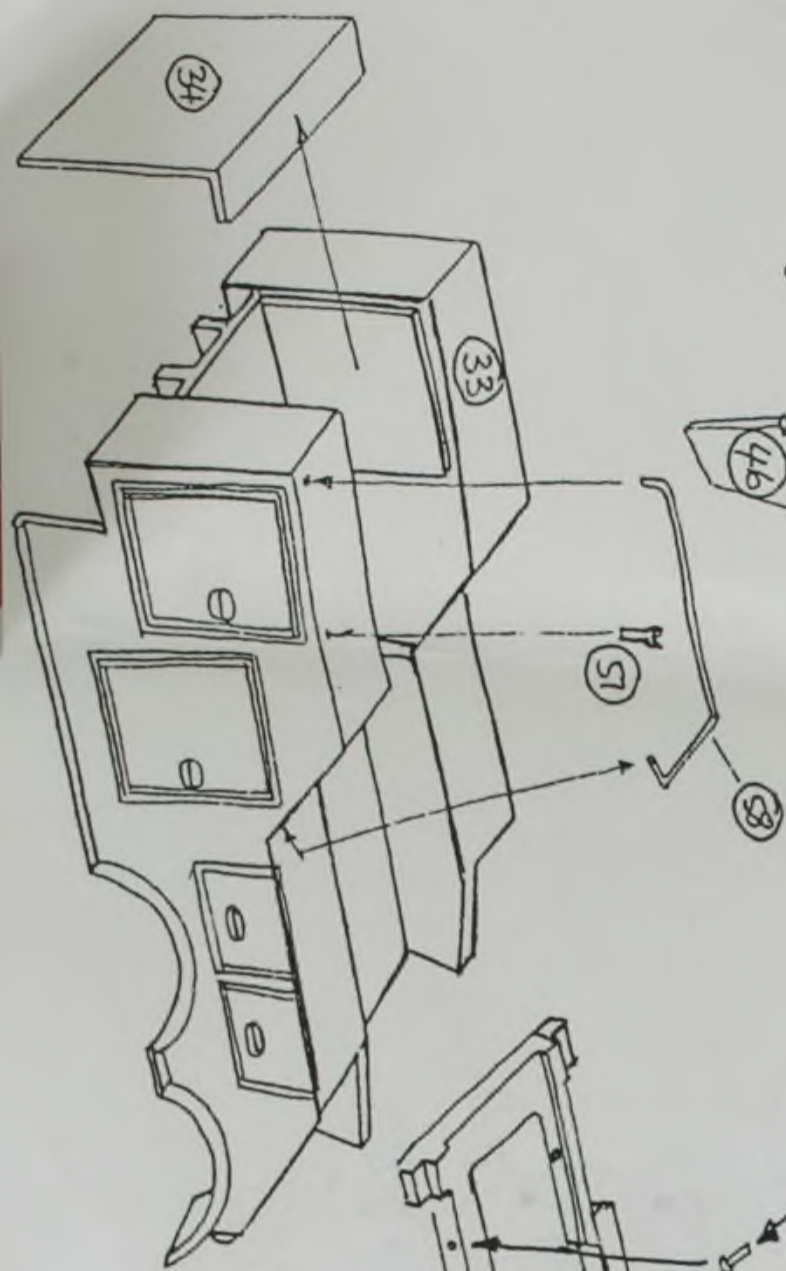

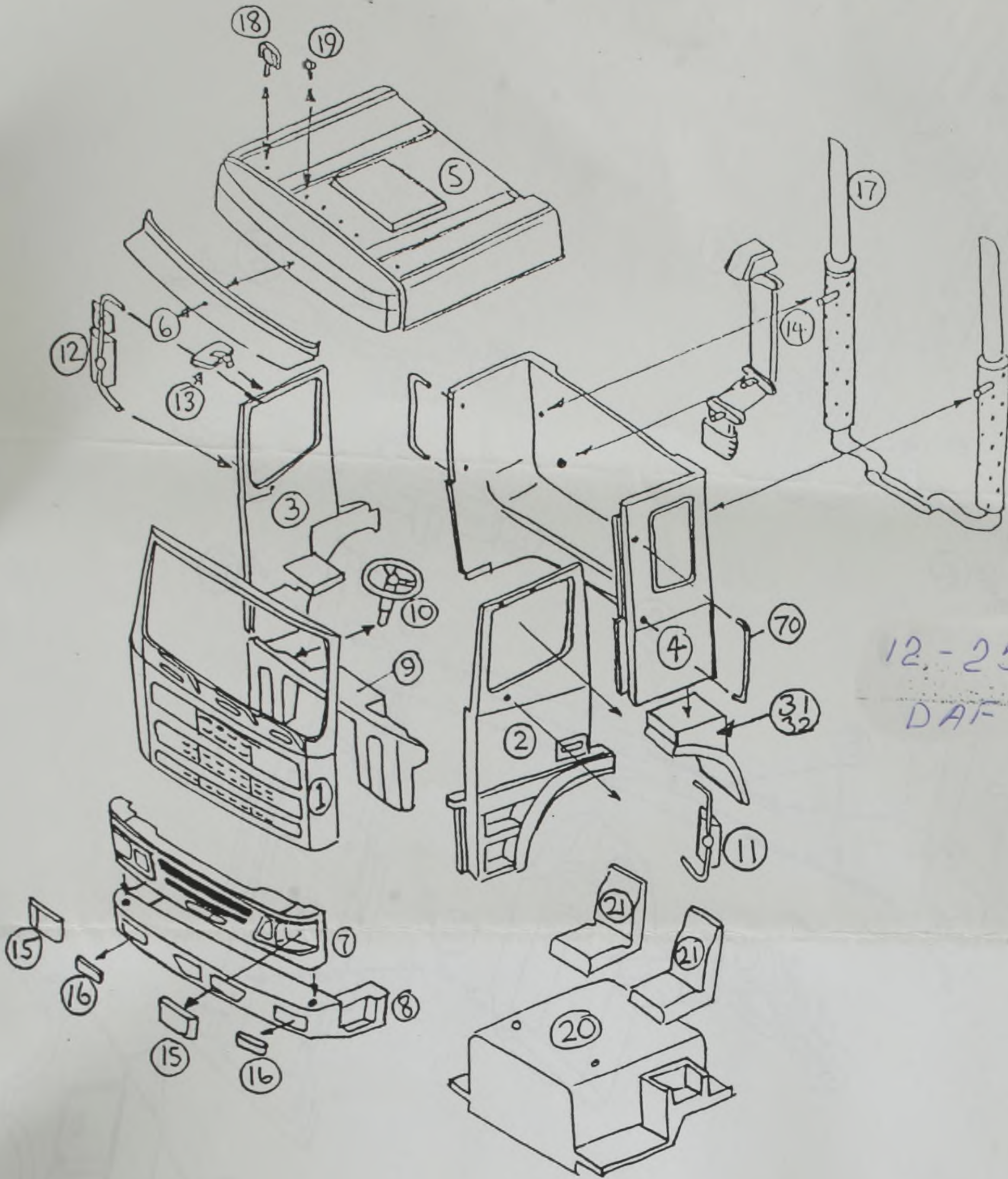

12-258

DAF