

STANDARD EQUIPMENT

ENGINE

- Engine, HINO P11C-VN, diesel engine with turbocharger and intercooler
- Automatic engine deceleration
- Auto Idle Stop (AIS)
- Batteries (2 x 12V - 176Ah)
- Starting motor (24V - 5 kW), 60 amp alternator
- Automatic engine shut-down for low engine oil pressure
- Engine oil pan drain cock
- Double element air cleaner
- Refueling pump

CONTROL

- Working mode selector (H-mode, S-mode and ECO-mode)
- Power Boost
- Heavy lift
- Object Handling Kit (boom and arm safety valve + hook) without ME ver.
- Extra N&B piping (proportional hand control) without ME ver.

SWING SYSTEM & TRAVEL SYSTEM

- Swing rebound prevention system
- Straight propel system
- Two-speed travel with automatic shift down
- Sealed & lubricated track links
- Grease-type track adjusters
- Automatic swing brake

HYDRAULIC

- Arm regeneration system
- Auto warm up system
- Aluminum hydraulic oil cooler
- Hydraulic fluid filter clog detector
- Quick hitch piping (without ME ver.)

MIRRORS, LIGHTS & CAMERAS

- Rearview mirror
- Three front working lights
- Rear & right side camera

CAB & CONTROL

- Two control levers, pilot-operated
- Horn, electric
- Cab light (interior)
- Luggage tray
- Large cup holder
- Detachable two-piece floor mat
- Headrest
- Handrails
- Intermittent windshield wiper with double-spray washer
- Skylight
- Tinted safety glass
- Pull-up type front window and removable lower front window
- Easy-to-read multi-display color monitor
- Automatic air conditioner
- Emergency escape hammer
- Air suspension seat with heater
- Radio, AM/FM stereo with speaker
- USB pin
- TOP guard
- Remote machine monitoring system "KOMEX5"
- Tow eyes

OPTIONAL EQUIPMENT

- ME specification
- Various optional arms
- Wide range of shoes
- Additional track guide
- Two cab lights
- Mechanical suspension seat (Optional for N&B piping specification)
- Rain visor (may interfere with bucket action)
- Cab guard
- Quick hitch piping (ME ver.)
- Travel alarm
- Lower Under Cover
- Hydraulic pressure adjustment function for N&B piping
- Object Handling Kit (boom and arm safety valve + hook) (ME ver.)

Note: Standard and optional equipment may vary. Consult your KOBELCO dealer for specifics.

Note: This catalog may contain attachments and optional equipment that are not available in your area. And it may contain photographs of machines with specifications that differ from those of machines sold in your areas. Please consult your nearest KOBELCO distributor for those items you require. Specialist equipment is needed to use this machine in demolition work. Before using it please contact your KOBELCO dealer. Due to our policy of continuous product improvements all designs and specifications are subject to change without advance notice. Copyright by **KOBELCO CONSTRUCTION MACHINERY CO., LTD.** No part of this catalog may be reproduced in any manner without notice.

KOBELCO CONSTRUCTION MACHINERY CO., LTD.

17-1, Higashigotanda 2-chome, Shinagawa-ku, Tokyo 141-8626 JAPAN
Tel: +81 (0) 3-5789-2146 Fax: +81 (0) 3-5789-2135
www.kobelco-kenki.co.jp/english_index.html

Inquiries To:

KOBELCO**SK500_{LC}**

■ **Bucket Capacity :**

1.4 - 3.4 m³

■ **Engine Power :**

271 kW / 1,850 min⁻¹

■ **Operating Weight :**

49,900 kg - 52,800 kg

Power Meets Efficiency

Higher fuel efficiency means "Efficiency"

Increase in productivity means "Power"



To urban centers, and to mines around the world. Kobelco's all-out innovation brings you durable earth-friendly construction machinery that's equal to any task, at sites all over the planet. Increased power and even greater fuel economy bring higher efficiency to any project. Kobelco SK500LC machines are also more durable than ever, able to withstand the rigors of the toughest job sites. It all adds up to new levels of value that are a step ahead of the times. Also, this machine conforms to Stage IV Exhaust Emission Standards, thanks to its significantly reduced NOx* emissions. While focusing on the global environment of the future, Kobelco offers next-generation productivity to meet the need for lower life cycle costs and exceed the expectations of customers the world over.

* NOx: Nitrogen Oxide



SK500_{LC}

Evolution Continues, with Improved Fuel Efficiency.

Higher fuel efficiency means "Efficiency"



The new arm interflow system more efficiently controls hydraulic fluid flow, and significant reduction of in-line resistance and pressure loss boosts fuel efficiency. The engine, already well-known for its environmental performance has a new SCR* system, and its reduced NOx emissions means the engine now meets Stage IV Standards.

* SCR: Selective Catalytic Reduction

Hydraulic System: Revolutionary Technology Saves Fuel

Arm Interflow System **NEW**

When lowering the boom, this system uses the downward force generated by the boom's weight to push fluid to the shovel arm. This greatly reduces the need to apply power from outside the system.

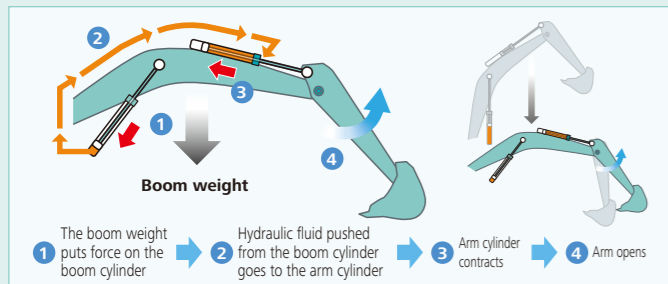

Hydraulic Circuit Reduces Energy Loss

We have made every effort to enhance fuel efficiency by minimizing hydraulic pressure resistance, improving the hydraulic line layout to control friction resistance loss and minimizing valve resistance.

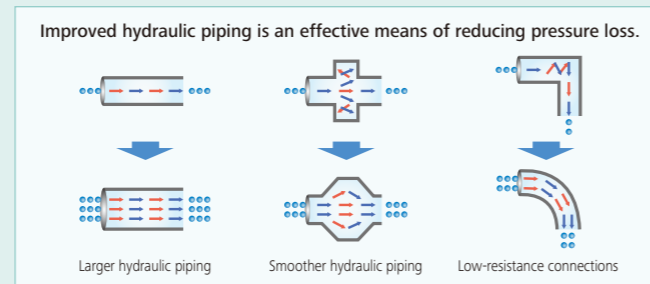

Built to operate in tough working environment

Hydraulic Drive for Engine Cooling Fan; **NEW** Independent Oil Cooler Fan

Hydraulic drive optimizes the cooling fan rotation speed to improve fuel economy and reduce noise. Also, the independent oil cooler fan better matches cooling to the hydraulic oil temperature, for optimal oil temperature control.



Conforms to Tier IV Final exhaust emissions standards

Reduces Fuel Consumption and Minimizes Exhaust Emissions

Hino engines are renowned for fuel efficiency and environmental performance, and KOBELCO has tuned them specifically for construction machinery. The high-pressure common rail fuel injection system, the variable-geometry (VG) turbocharger, and the exhaust gas recirculation (EGR) system reduce particulate matter (PM) while the large EGR cooler greatly reduces the formation of nitrogen oxide (NOx) gases.



VG Turbo Reduces PM

The variable-geometry turbocharger adjusts air intake to maximize combustion efficiency. At low engine speeds the nozzles are closed, the turbo speed increased and air intake is boosted. This helps lower fuel consumption.

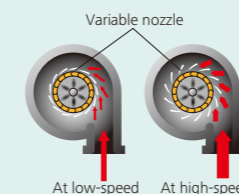

SCR System with DEF/Urea **NEW**

Engine exhaust system utilizes Selective Catalytic Reduction (SCR) to convert NOx* into harmless nitrogen and water emissions. SCR combined with a Diesel Particulate Filter (DPF) makes a much cleaner machine meeting U.S. EPA regulations for Tier IV final.

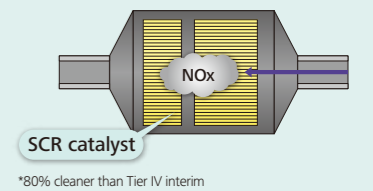

EGR Cooler Reduces NOx

Cooled exhaust gases from the EGR cooler are mixed with fresh air in the intake. The recirculated air lowers the combustion temperature which reduces NOx.

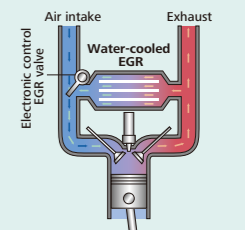

In Pursuit of Improved Fuel Efficiency

ECO-mode further reduces fuel consumption **Operation Mode**

Fuel consumption is lower in ECO-mode in comparison with the previous model (Generation 9).

■ Compared to previous models

E ECO-mode...About **6%** improvement

Always and Forever. Yesterday, Today, and Tomorrow. Obsessed with Fuel Efficiency.

Over the past 10 years, Kobelco has achieved an average reduction of about 36% in fuel consumption. And we vow to continue to lead in fuel efficiency.

■ Compared to SK480LC-6 model (2006)

E ECO-mode (SK500LC-10)...About **36%** improvement

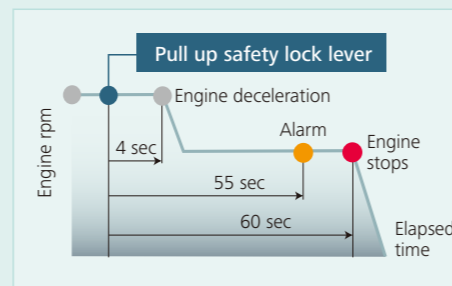

AIS (Auto Idle Stop)

If the boarding/disembarking lever is left up, the engine will stop automatically. This eliminates wasteful idling during standby, saving fuel and reducing CO₂ emissions as well.

More Power and Higher Efficiency

The highly efficient hydraulic system minimizes fuel consumption while maximizing power. With nimble movement and ample digging power, this excavator promises to improve your job productivity.

Improved fuel efficiency contributes to high performance

Improved excavating load Digging Volume

This excavator offers dynamic digging force even as it minimizes fuel consumption rates, achieving class-leading work volume. H-mode, sometimes with an increased torque setting, delivers about 13% greater digging volume.

■ Digging volume/hour
(Compared to H-mode on previous models)



S S-mode...About 8% improvement

H H-mode...About 13% improvement

■ Max. Bucket Digging Force
Normal: 267 kN
With power boost: 292 kN

■ Max. Arm Crowding Force
Normal: 203 kN
With power boost: 222 kN



Get More Done Faster with Superior Operability

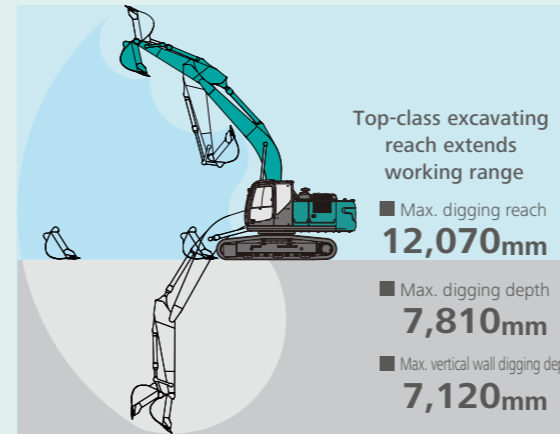

Piping for Quick Hitch (optional)



A quick hitch hydraulic line, which speeds up attachment changes, is available as a standard, it is optional on ME ver.

A Light Touch on the Lever NEW Means Smoother, Less Tiring Work



It takes 25%* less effort to work the operation lever, which reduces fatigue over long working hours or continued operations.

*Compared to SK500LC-9

Top Class Traveling Force

Powerful traveling force and pulling force deliver plenty of speed when climbing slopes or negotiating bad roads, and the agility to change direction swiftly and smoothly.



■ Drawbar Pulling Force: 415kN

MVLC

Crawler length can be adjusted by fixing bolt positions to comply with transport regulations.

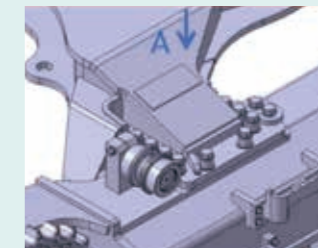

Double Grouser Shoe (optional)

Double grouser shoes are available as an option.



Operator-friendly Features Include Controls that Are Easy to See, Easy to Use



Multi-Display in Color

Brilliant colors and graphic displays are easy to recognize on the LCD multi-display in the console. The display shows fuel consumption, maintenance intervals, and more.

- 1 Analog gauge provides an intuitive reading of fuel level and engine water temperature
- 2 Green indicator light shows low fuel consumption during operation
- 3 PM accumulation display (left)/Urea level gauge (right)
- 4 Fuel consumption/Switch indicator for rear camera images
- 5 Digging mode switch
- 6 Monitor display switch

One-Touch Attachment Mode Switch

A simple flick of a switch converts the hydraulic circuit and flow amount to match attachment changes. Icons help the operator to confirm the proper configuration at a glance.



Increased Power, with Enhanced Durability to Maintain the Machine's Value

Increase in productivity means "Power"

Structural design increases strength, while eliminating hydraulic problems. Enhanced durability takes productivity to a new level.



Improved Filtration System Reliability

Clean, contaminant-free fuel and hydraulic fluid are essential to stable performance. The improved filtration systems reduce the risk of mechanical trouble and enhance longevity and durability.

Hydraulic Fluid Filter **NEW**

Recognized as the best in the industry, our super-fine filter separates out even the smallest particles. New cover prevents contamination when changing filters.



Hydraulic Fluid Filter Clog Detector **NEW**

Pressure sensors at the inlet and outlet of the hydraulic fluid filter monitor differences in pressure to determine the degree of clogging. If the difference in pressure exceeds a predetermined level, a warning appears on the multi-display, so any contamination can be removed from the filter before it reaches the hydraulic fluid reservoir.

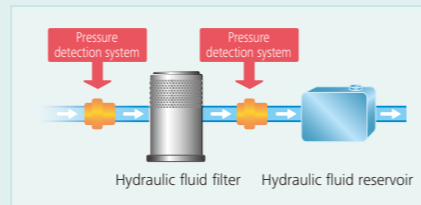

Increased Filtering Capacity for Hydraulic Oil **NEW**

Two filters are installed for returning hydraulic oil, to curb clogging and increase the durability and reliability of the hydraulic equipment. Filtering capacity 1.8 times greater than previous model (Generation-9).



Double-Element Air Cleaner

The large-capacity element features a double-filter structure that keeps the engine running clean even in industrial environments.



Fuel Filter **NEW**

The pre-filter, with built-in water separator maximizes filtering performance.

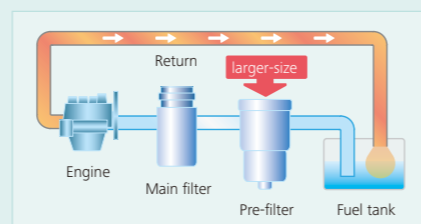

Pump Drain Filter **NEW**

Newly installed pump drain filter boosts pump reliability.

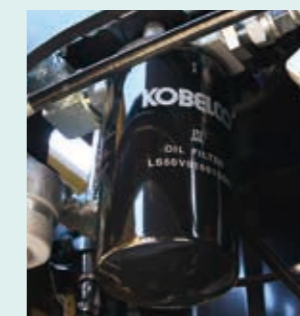

Pilot Filter

A new cartridge-type pilot filter simplifies maintenance.



Comfortable Cab Is Now Safer than Ever

A work environment that is quieter and more comfortable. A cab that puts the operator first is key to improved safety.



Comfort

Super-Airtight Cab



The high level of air-tightness keeps dust out of the cab.

Quiet Inside

The high level of air-tightness ensures a quiet, comfortable cabin interior.

Low Vibration

Coil springs absorb small vibrations, and high suspension mounts filled with silicone oil reduce heavy vibration. The long stroke achieved by this system provides excellent protection from vibration.

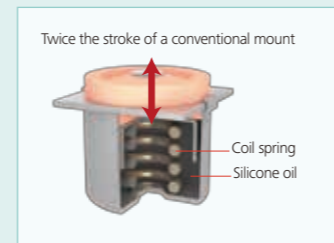

Air Conditioner ^{NEW} Register behind the Seat



The large air-conditioner has registers on the back pillars that blow from behind and to the right and left of the operator's seat. They can be adjusted to put a direct flow of cool/warm air on the operator, which means a more comfortable operating environment.

More Comfortable Seat Means Higher Productivity



Interior Equipment Adds to Comfort and Convenience

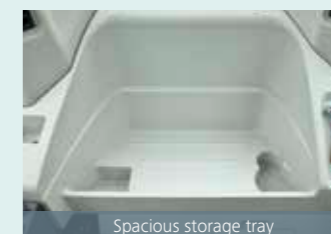

Large Cab Is Easy to Get In and Out of

The expanded cab provides plenty of room for a large door, more headroom and smoother entry and exit.

Safety

ROPS Cab

ROPS (Roll-Over-Protective Structure)-compliant cab clears ISO standards (ISO-12117-2: 2008) and ensures greater safety for the operator should the machine tip over.



Expanded Field of View for Greater Safety

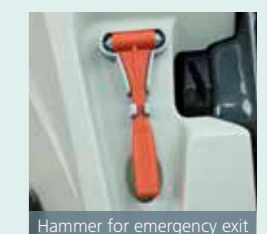
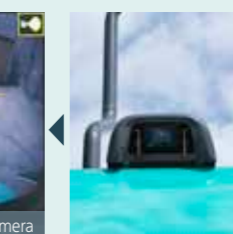

Right Side Camera Fitted as Standard

In addition to the existing rear-view camera, a camera for the right side is fitted as standard for easy safety checks all around the machine.

Rear view shows the area directly behind the cab.

Broad View Liberates the Operator

The front window features one large piece of glass without a center pillar on the right side for a wide, unobstructed view.



Direct Access to Operational Status

Location Data

• Accurate location data can be obtained even from sites where communications are difficult.

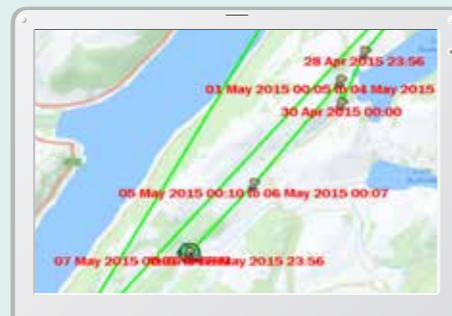
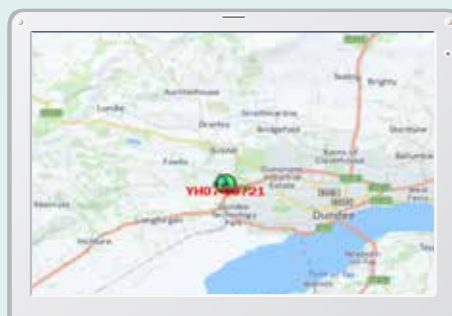

Operating Hours

- A comparison of operating times of machines at multiple locations shows which locations are busier and more profitable.
- Operating hours on site can be accurately recorded, for running time calculations needed for rental machines, etc.

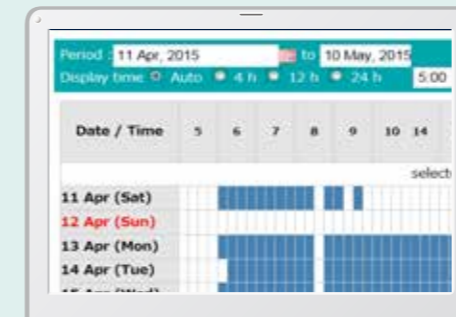

Fuel Consumption Data

- Data on fuel consumption and idling times can be used to indicate improvements in fuel consumption.

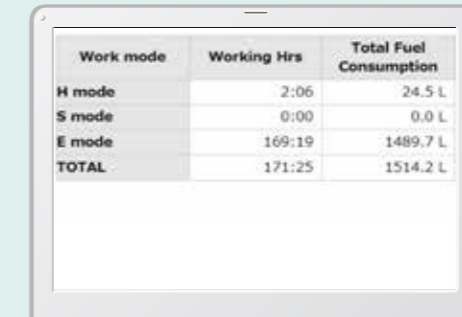

Graph of Work Content

- The graph shows how working hours are divided among different operating categories, including digging, idling, traveling and optional operations.



Maintenance Data and Warning Alerts

Machine Maintenance Data

- Provides maintenance status of separate machines operating at multiple sites.
- Maintenance data is also relayed to KOBELCO service personnel, for more efficient planning of periodic servicing.

Maintenance

Model	Serial No.	Hour Meter	Engine Oil
SK135SRLC-3/SK140SRL	YH07-09721	734 Hr	434
SK135SRLC-3/SK140SRL	YH07-09789	73 Hr	429
SK210LC-9	YQ13-10454	960 Hr	58
SK210LC-9	YQ13-10481	549 Hr	498
SK75SR-	YT08-20174		

Warning Alerts

- This system warns an alert if an anomaly is sensed, preventing damage that could result in machine downtime.

Alarm Information Can Be Received through E-mail

- Alarm information or maintenance notice can be received through E-mail, using a computer or cell phone.



Alarm messages can be received on mobile device.

Daily/Monthly Reports

- Operational data downloaded onto a computer helps in formulating daily and monthly reports.

Security System

Engine Start Alarm

- The system can be set an alarm if the machine is operated outside designated time.



Area Alarm

- It can be set an alarm if the machine is moved out of its designated area to another location.



Efficient Maintenance Keeps the Machine in Peak Operating Condition



MAINTENANCE			
			13.8h
	INTERVAL	REMAINING TIME	EXCHANGE DAY
ENGINE OIL	500	498	--/--/--
FUEL FILTER	500	498	--/--/--
HYD. FILTER	1000	998	--/--/--
HYD. OIL	5000	4998	--/--/--

Machine Information Display Function

- Displays only the maintenance information that's needed, when it's needed
- Self-diagnostic function provides early-warning detection and display of electrical system malfunctions
- Service-diagnostic function makes it easier to check the status of the machine
- Record function for previous breakdowns including irregular and transient malfunction

Examples of displaying maintenance information

Easy, On-the-Spot Maintenance NEW

There is ample space in the engine compartment for a mechanic to do maintenance work inside. The distance between steps are lower so entry and exit is easier. And the mechanic can work in comfort, without contortions or unnatural body positions. Finally, the hood is lighter and easier to raise and lower.

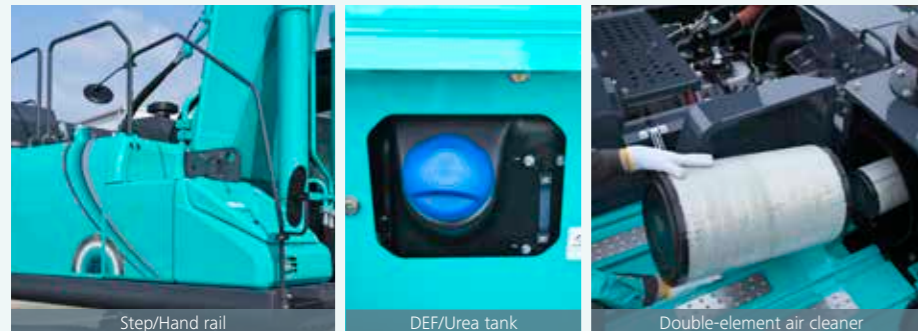

Ground Level Access

Laid out for easy access to radiator and cooling system elements.



More Efficient Maintenance Inside the Cab



More finely differentiated fuses make it easier to locate malfunctions.

Internal and external air conditioner filters can be easily removed without tools for cleaning.

If the monitor warning goes off, the filter should be reactivated manually using a switch.

Maintenance Work, Daily Checks, Etc., Can Be Done from Ground Level

The layout allows for easy access from the ground for many daily checks and regular maintenance tasks.

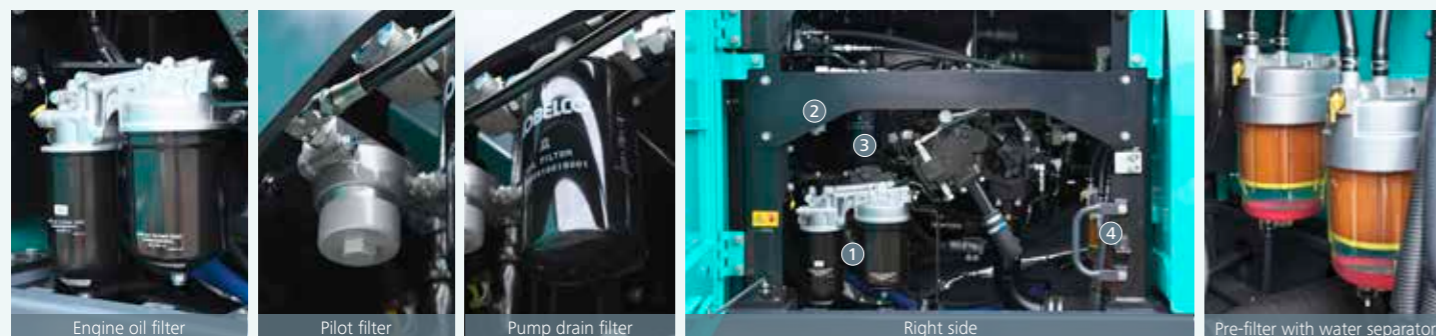

- 1 Engine oil filter
- 2 Pilot filter
- 3 Pump drain filter
- 4 Pre-filter with water separator

Easy Cleaning



Special sloped crawler side frame design is easily cleaned of mud.



Detachable two-piece floor mat with handles for easy removal. A floor drain is located under the floor mat.

Engine oil pan equipped with drain valve.

Long-life hydraulic oil:
5,000 hours

Long-Interval Maintenance

Long-life hydraulic oil reduces cost and labor.

Replacement cycle:
1,000 hours

Highly Durable Super-fine Filter

The high-capacity hydraulic oil filter incorporates glass fiber with superior cleaning power and durability.



Engine

Model	HINO P11C-VN
Type	Water-cooled, 4cycle 6cylinder direct injection type diesel engine with intercooler turbo-charger (Stage IV-compliant engine)
No. of cylinders	6
Bore and stroke	122 mm x 150 mm
Displacement	10.52 L
Rated power output	Net 271 kW/1,850 min ⁻¹ (ISO 14396 : without fan)
Max. torque	Net 1,470 N·m/1,400 min ⁻¹ (ISO 14396 : without fan)

Hydraulic System

Pump	
Type	Two variable displacement pumps + One gear pump
Max. discharge flow	2 x 370 L/min, 1 x 63.5 L/min
Relief valve setting	
Excavating circuits (main)	31.4 Mpa
Power boost	34.3 Mpa
Travel circuit	34.3 Mpa
Swing circuit	25.8 Mpa
Pilot control circuit	5.0 Mpa
Pilot control pump	Gear type
Main control valve	8-spool
Oil cooler	Air cooled type

Swing System

Swing motor	Axial piston motor
Parking brake	Oil disk brake, hydraulic operated automatically
Swing speed	7.6 min ⁻¹
Swing torque	183 kN·m
Tail swing radius	3,800 mm
Min front swing radius	5,140 mm

Attachments

Backhoe bucket and combination

Use	Backhoe bucket	Backhoe bucket						
		Normal digging			Light-duty		Mass excavating	
Bucket capacity ISO heaped	m ³	1.4	1.6	1.9	2.1	2.4	3.4	
Struck	m ³	1.0	1.15	1.4	1.5	1.7	2.5	
Opening width	With side cutter	mm	1,225	1,375	1,670	1,750	1,980	1,990
	Without side cutter	mm	1,100	1,250	1,550	1,620	1,850	1,870
No. of teeth		4	4	5	5	5	6	
Bucket weight	kg	1,250	1,330	1,510	1,560	1,690	2,190	
Combination	3.0m short arm	○	○	○	△	△	×	
	3.45m standard arm	○	○	◎	△	×	×	
	4.04m long arm	○	◎	△	×	×	×	
	6.3m ME boom and 2.4 ME arm	×	×	×	×	×	○*	

◎ Standard ○ Recommend △ Loading only × Not recommended

*ME arm specs should be used for light-digging.

Travel System

Travel motors	2 x axial-piston, two-step motors
Travel brakes	Hydraulic brake per motor
Parking brakes	Oil disk brake per motor
Travel shoes	50 each side
Travel speed (high/low)	5.4/3.4 km/h
Drawbar pulling force	415 kN
Gradeability	70 % (35 deg)
Ground clearance	510 mm

Cab & Control

Cab	
All-weather, sound-suppressed steel cab mounted on the high suspension mounts filled with silicone oil and equipped with a heavy, insulated floor mat.	
Control	
Two hand levers or two foot pedals for forward and backward operations of each track independently.	
Noise levels	
External	104 dB(A) (ISO 6395)
Operator	69 dB(A) (ISO 6396)

Boom, Arm & Bucket

Boom cylinders	170 mmx1,590 mm
Arm cylinder	190 mmx1,970 mm
Bucket cylinder	160 mmx1,410 mm

Refilling Capacities & Lubrications

Fuel tank	638 L
Cooling system	47.4 L
Engine oil	42.5 L
Travel reduction gear	2x15 L
Swing reduction gear	2x5 L
Hydraulic oil tank	370.8 L tank oil level 631 L hydraulic system
DEF/Urea tank	83 L

Working Ranges

Unit: m

Boom	Arm	7.0 m*			
		ME (MVLC) 2.4Arm	Short 3.0Arm	Standard 3.45Arm	Long 4.04Arm
a- Max. digging reach		10.88	11.77	12.07	12.61
b- Max. digging reach at ground level		10.63	11.54	11.84	12.4
c- Max. digging depth		6.48	7.36	7.81	8.4
d- Max. digging height		10.85	11.16	10.93	11.14
e- Max. dumping clearance		6.92	7.72	7.58	7.79
f- Min. dumping clearance		3.11	3.22	2.77	2.18
g- Max. vertical wall digging depth		5.49	6.68	7.12	7.5
h- Min. swing radius		4.78	5.28	5.14	5.21
i- Horizontal digging stroke at ground level		3.9	5.21	6.1	7.07
j- Digging depth for 2.4 m (8') flat bottom		6.31	7.21	7.67	8.27
Bucket capacity ISO heaped m ³		3.4	2.1	1.9	1.6

*As boom hoot of MVLC is 120mm higher than rigid type, working range of MVLC rise 120mm higher than rigid type.

Digging Force (ISO 6015)				
Unit: kN				
Arm length	ME (MVLC) 2.4Arm	Short 3.0Arm	Standard 3.45Arm	Long 4.04Arm
Bucket digging force	282/308*	266/291*	267/292*	289/264*
Arm crowding force	249/272*	223/244*	203/222*	198/181*

*Power Boost engaged.

Dimensions

Unit: mm

Arm length	ME (MVLC) 2.4Arm	Short 3.0Arm	Standard 3.45Arm	Long 4.04Arm
A Overall length	11,910	12,170	12,140	12,190
B Overall height (to top of boom)	4,240	3,780	3,570	3,720
C Overall width of crawler	Rigid type	3,350		
	MVLC type	3,490(2,990)		
D Overall height (to top of cab)	3,380			
E Ground clearance of rear end*	1,340*			
F Ground clearance*	510*			
G Tail swing radius	3,800			
G' Distance from center of swing to rear end	3,800			
H Tumbler distance	Rigid type	4,400		
	MVLC type	4,400		
I Overall length of crawler	Rigid type	5,450		
	MVLC type	5,460		
J Track gauge	Rigid type	2,750		
	MVLC type	2,890(2,390)		
K Shoe width	600			
L Overall width of upperstructure	2,980			

*Without including height of shoe lug.

Operating Weight & Ground Pressure

In standard trim, with standard boom, 3.45 m arm, and 1.9 m³ ISO heaped bucket

Shaped	Double grouser shoes (even height)	Triple grouser shoes (even height)			
		HD		Standard	
Shoe width	mm	600		800	900
Overall width of crawler	Rigid type	3,350			
	MVLC type	3,490(2,990)			
Ground pressure	Rigid type	86	86	86	66
	MVLC type	89	89	88	68
Operating weight	Rigid type	50,200	50,300	49,900	51,300
	MVLC type	51,700	51,800	51,400	52,800

In standard trim, MVLC type with 6.3 m ME boom, 2.4 m ME arm, and 3.4 m³ ISO heaped bucket

Shaped	Double grouser shoes (even height)	Triple grouser shoes (even height)			
		HD		Standard	
Shoe width	mm	600		800	
Overall width of crawler	mm	3,490(2,990)			
Ground pressure	kPa	90	90	88	68
Operating weight	kg	52,300	52,400	51,300	52,800

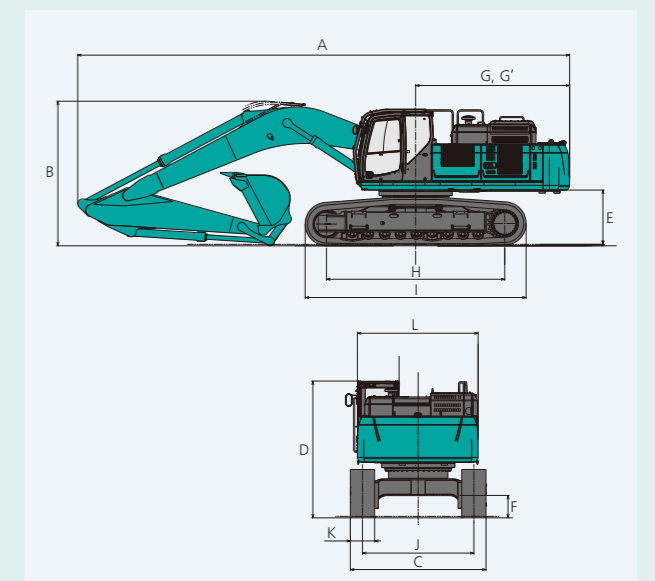
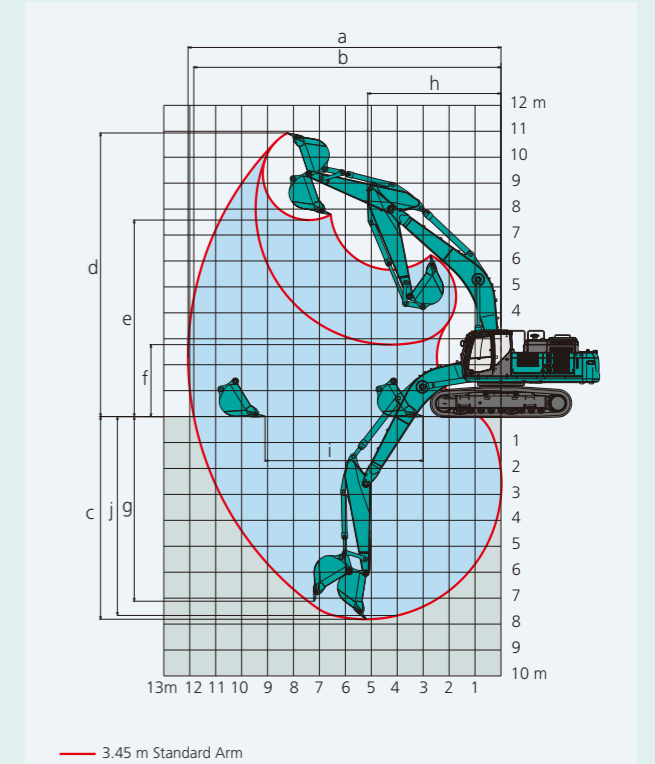

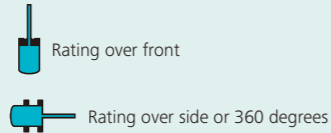
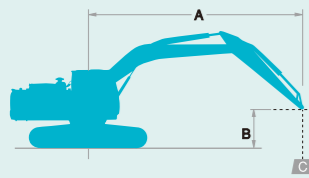

A: Reach from swing centerline to arm top
 B: Arm top height above/below ground
 C: Lifting capacities in Kilograms
 Bucket: Without bucket
 Relief valve setting: 34.3 MPa

Undercarriage:Rigid type

SK500LC-10		Boom: 7.0 m Arm: 3.45 m Bucket: without Counterweight: 9,800 kg Shoe: 600 mm (Heavy Lift)												
		3.0 m		4.5 m		6.0 m		7.5 m		9.0 m		At Max. Reach		Radius
B	A	Rating over front	Rating over side or 360 degrees	Rating over front	Rating over side or 360 degrees	Rating over front	Rating over side or 360 degrees	Rating over front	Rating over side or 360 degrees	Rating over front	Rating over side or 360 degrees	Rating over front	Rating over side or 360 degrees	
9.0 m	kg											*10,330	*10,330	7.76m
7.5 m	kg											*10,090	8,800	8.85m
6.0 m	kg							*10,670	*10,670	*10,150	8,500	*9,890	7,600	9.59m
4.5 m	kg			*18,060	*18,060	*13,830	*13,830	*11,760	10,950	*10,640	8,280	*9,980	6,910	10.04m
3.0 m	kg			*22,800	21,440	*16,130	14,300	*13,020	10,430	*11,310	8,000	*10,330	6,540	10.26m
1.5 m	kg			*14,800	*14,800	*18,010	13,530	*14,160	9,980	*11,960	7,740	10,330	6,420	10.25m
G.L.	kg			*18,080	*18,080	*19,070	13,090	*14,930	9,670	12,300	7,560	10,590	6,550	10.01m
-1.5 m	kg	*13,040	*13,040	*25,670	19,790	*19,230	12,930	*15,140	9,530	12,230	7,500	11,320	6,980	9.53m
-3.0 m	kg	*22,230	*22,230	*24,140	20,010	*18,450	12,990	*14,550	9,570			*11,810	7,870	8.76m
-4.5 m	kg	*28,130	*28,130	*21,140	20,480	*16,350	13,300	*12,370	9,880			*11,980	9,680	7.63m

Undercarriage:Rigid type

SK500LC-10		Boom: 7.0 m Arm: 3.0 m Bucket: without Counterweight: 9,800 kg Shoe: 600 mm (Heavy Lift)												
		3.0 m		4.5 m		6.0 m		7.5 m		9.0 m		At Max. Reach		Radius
B	A	Rating over front	Rating over side or 360 degrees	Rating over front	Rating over side or 360 degrees	Rating over front	Rating over side or 360 degrees	Rating over front	Rating over side or 360 degrees	Rating over front	Rating over side or 360 degrees	Rating over front	Rating over side or 360 degrees	
9.0 m	kg											*11,290	*11,290	7.36m
7.5 m	kg							*10,790	*10,790			*10,930	9,310	8.51m
6.0 m	kg							*11,330	11,310	*10,800	8,420	*10,850	7,980	9.27m
4.5 m	kg			*19,670	*19,670	*14,670	*14,670	*12,350	10,860	*11,150	8,240	*10,920	7,240	9.74m
3.0 m	kg					*16,880	14,140	*13,540	10,380	*11,740	8,000	10,940	6,860	9.96m
1.5 m	kg					*18,550	13,460	*14,570	9,970	*12,290	7,770	10,830	6,760	9.95m
G.L.	kg			*13,600	*13,600	*19,340	13,110	*15,180	9,710	12,370	7,630	11,150	6,920	9.70m
-1.5 m	kg	*10,230	*10,230	*23,800	20,000	*19,220	13,030	*15,180	9,620	*12,260	7,630	*11,820	7,430	9.21m
-3.0 m	kg	*22,180	*22,180	*23,330	20,280	*18,090	13,160	*14,240	9,730			*11,980	8,480	8.41m
-4.5 m	kg	*25,410	*25,410	*19,810	*19,810	*15,410	13,550					*11,760	10,680	7.22m

Undercarriage:Rigid type

SK500LC-10		Boom: 7.0 m Arm: 4.04 m Bucket: without Counterweight: 9,800 kg Shoe: 600 mm (Heavy Lift)																
		1.5 m		3.0 m		4.5 m		6.0 m		7.5 m		9.0 m		10.5 m		At Max. Reach		Radius
B	A	Rating over front	Rating over side or 360 degrees	Rating over front	Rating over side or 360 degrees	Rating over front	Rating over side or 360 degrees	Rating over front	Rating over side or 360 degrees	Rating over front	Rating over side or 360 degrees	Rating over front	Rating over side or 360 degrees	Rating over front	Rating over side or 360 degrees	Rating over front	Rating over side or 360 degrees	
9.0 m	kg															*8,740	*8,740	8.47m
7.5 m	kg															*9,090	8,690	9.48m
6.0 m	kg															*9,310	8,550	10.17m
4.5 m	kg																	10.60m
3.0 m	kg																	10.80m
1.5 m	kg																	10.79m
G.L.	kg			*6,600	*6,600	*19,640	*19,640	*18,480	12,990	*14,440	9,560	*12,000	7,430	9,750	5,990	9,660	5,930	10.57m
-1.5 m	kg	*8,680	*8,680	*12,720	*12,720	*24,690	19,460	*19,010	12,720	*14,890	9,350	12,040	7,300			10,240	6,270	10.11m
-3.0 m	kg	*14,920	*14,920	*19,830	*19,830	*24,800	19,580	*18,630	12,700	*14,660	9,320	*11,760	7,330			*11,000	6,960	9.40m
-4.5 m	kg			*29,250	*29,250	*22,430	19,950	*17,130	12,910	*13,340	9,500					*11,300	8,310	8.35m
-6.0 m	kg					*18,040	*18,040	*13,630	13,440							*11,250	*11,250	6.81m

Undercarriage:MVLC type

SK500LC-10		Boom: 7.0 m Arm: 3.45 m Bucket: without Counterweight: 9,800 kg Shoe: 600 mm (Heavy Lift)												
		3.0 m		4.5 m		6.0 m		7.5 m		9.0 m		At Max. Reach		Radius
B	A	Rating over front	Rating over side or 360 degrees	Rating over front	Rating over side or 360 degrees	Rating over front	Rating over side or 360 degrees	Rating over front	Rating over side or 360 degrees	Rating over front	Rating over side or 360 degrees	Rating over front	Rating over side or 360 degrees	
9.0 m	kg											*10,300	*10,300	7.87m
7.5 m	kg											*10,060	9,330	8.93m
6.0 m	kg							*10,750	*10,750	*10,170	9,130	*9,890	8,110	9.63m
4.5 m	kg			*18,450	*18,450	*14,010	*14,010	*11,860	11,740	*10,690	8,900	*10,000	7,420	10.07m
3.0 m	kg			*21,460	*21,460	*16,300	15,380	*13,120	11,210	*11,370	8,610	*10,370	7,050	10.27m
1.5 m	kg			*14,820	*14,820	*18,120	14,630	*14,240	10,770	*12,010	8,360	10,680	6,960	10.24m
G.L.	kg			*18,550	*18,550	*19,110	14,200	*14,970	10,460	*12,410	8,180	10,980	7,130	9.98m
-1.5 m	kg	*13,730	*13,730	*25,670	21,670	*19,210	14,060	*15,130	10,340	*12,330	8,130	*11,500	7,620	9.48m
-3.0 m	kg	*23,050	*23,050	*23,960	21,920	*18,340	14,150	*14,450	10,400			*11,830	8,630	8.69m
-4.5 m	kg	*27,630	*27,630	*20,820	*20,820	*16,090	14,480	*12,030	10,750			*11,980	10,720	7.51m

Undercarriage:MVLC type

SK500LC-10		Boom: 7.0 m Arm: 3.0 m Bucket: without Counterweight: 9,800 kg Shoe: 600 mm (Heavy Lift)												
		3.0 m		4.5 m		6.0 m		7.5 m		9.0 m		At Max. Reach		Radius
B	A	Rating over front	Rating over side or 360 degrees	Rating over front	Rating over side or 360 degrees	Rating over front	Rating over side or 360 degrees	Rating over front	Rating over side or 360 degrees	Rating over front	Rating over side or 360 degrees	Rating over front	Rating over side or 360 degrees	
9.0 m	kg													7.47m
7.5 m	kg											*10,810	*10,810	8.58m
6.0 m	kg											*11,400	*11,400	9.32m
4.5 m	kg											*10,810	9,050	9.76m
3.0 m	kg											*11,190	8,860	9.97m
1.5 m	kg											*10,930	7,770	9.94m
G.L.	kg											*11,200	7,310	9.94m
-1.5 m	kg											*12,320	8,390	9.94m
-3.0 m	kg	*11,180	*11,180	*24,790	21,880	*19,170	14,170	*15,150	10,430	*12,180	8,270	*11,840	8,110	9.15m
-4.5 m	kg											*11,980	9,300	8.33m

Undercarriage:MVLC type

SK500LC-10		Boom: 7.0 m Arm: 4.04 m Bucket: without Counterweight: 9,800 kg Shoe: 600 mm (Heavy Lift)																
		1.5 m		3.0 m		4.5 m		6.0 m		7.5 m		9.0 m		10.5 m		At Max. Reach		Radius
B	A	Rating over front	Rating over side or 360 degrees	Rating over front	Rating over side or 360 degrees	Rating over front	Rating over side or 360 degrees	Rating over front	Rating over side or 360 degrees	Rating over front	Rating over side or 360 degrees	Rating over front	Rating over side or 360 degrees	Rating over front	Rating over side or 360 degrees	Rating over front	Rating over side or 360 degrees	
9.0 m	kg																	8.57m
7.5 m	kg																	9.55m
6.0 m	kg																	10.21m
4.5 m	kg																	10.62m
3.0 m	kg																	10.81m
1.5 m	kg																	10.78m
G.L.	kg																	10.54m
-1.5 m	kg																	10.07m
-3.0 m	kg																	9.33m
-4.5 m	kg																	8.25m
-6.0 m	kg																	6.66m

Undercarriage:MVLC type

SK500LC-10		Boom: 6.3 m Arm: 2.4 m Bucket: without Counterweight: 9,800 kg Shoe: 600 mm (Heavy Lift)											
		3.0 m		4.5 m		6.0 m		7.5 m		At Max. Reach		Radius	
B	A	Rating over front	Rating over side or 360 degrees	Rating over front	Rating over side or 360 degrees	Rating over front	Rating over side or 360 degrees	Rating over front	Rating over side or 360 degrees	Rating over front	Rating over side or 360 degrees		
9.0 m	kg												5.77m
7.5 m	kg												7.16m
6.0 m	kg												8.03m
4.5 m	kg												8.55m
3.0 m	kg												8.78m
1.5 m	kg												8.74m
G.L.	kg												8.44m
-1.5 m	kg												7.84m
-3.0 m	kg												6.86m

Notes:

- Do not attempt to lift or hold any load that is greater than these lift capacities at their specified lift point radius and heights. Weight of all accessories must be deducted from the above lift capacities.
- Lift capacities are based on machine standing on level, firm, and uniform ground. User must make allowance for job conditions such as soft or uneven ground, out of level conditions, side loads, sudden stopping of loads, hazardous conditions, experience of personnel, etc.
- Arm top defined as lift point.
- The above lifting capacities are in compliance with ISO 10567. They do not exceed 87% of hydraulic lifting capacity or 75% of tipping load. Lifting capacities marked with an asterisk (*) are limited by hydraulic capacity rather than tipping load.
- Operator should be fully acquainted with the Operator's and Maintenance Instructions before operating this machine. Rules for safe operation of equipment should be adhered to at all times.
- Lift capacities apply to only machine as originally manufactured and normally equipped by KOBELCO CONSTRUCTION MACHINERY CO., LTD.