

Soilmec SR100



S/N 3409

Model Year 2008

Deutz TCD 2015 VO8

Transport		
Truck #	Parts	Weight
1	Car body	170,000lbs
2	Mast (82') stretch trailer	56,000lbs
3	Counterweight	45,000lbs
	Rotary	27,029lbs
4	Kelly bar	26,400lbs

Approx. operating weight (w/o Kelly –w/o tools)	147,159kg	324,429lbs
Tracks Extended/retracted	5100/3371mm	16' 9"/11' 1"
Max Pile Diameter	3000mm	9' 10"
Trucks needed to transport	4	

Working Condition

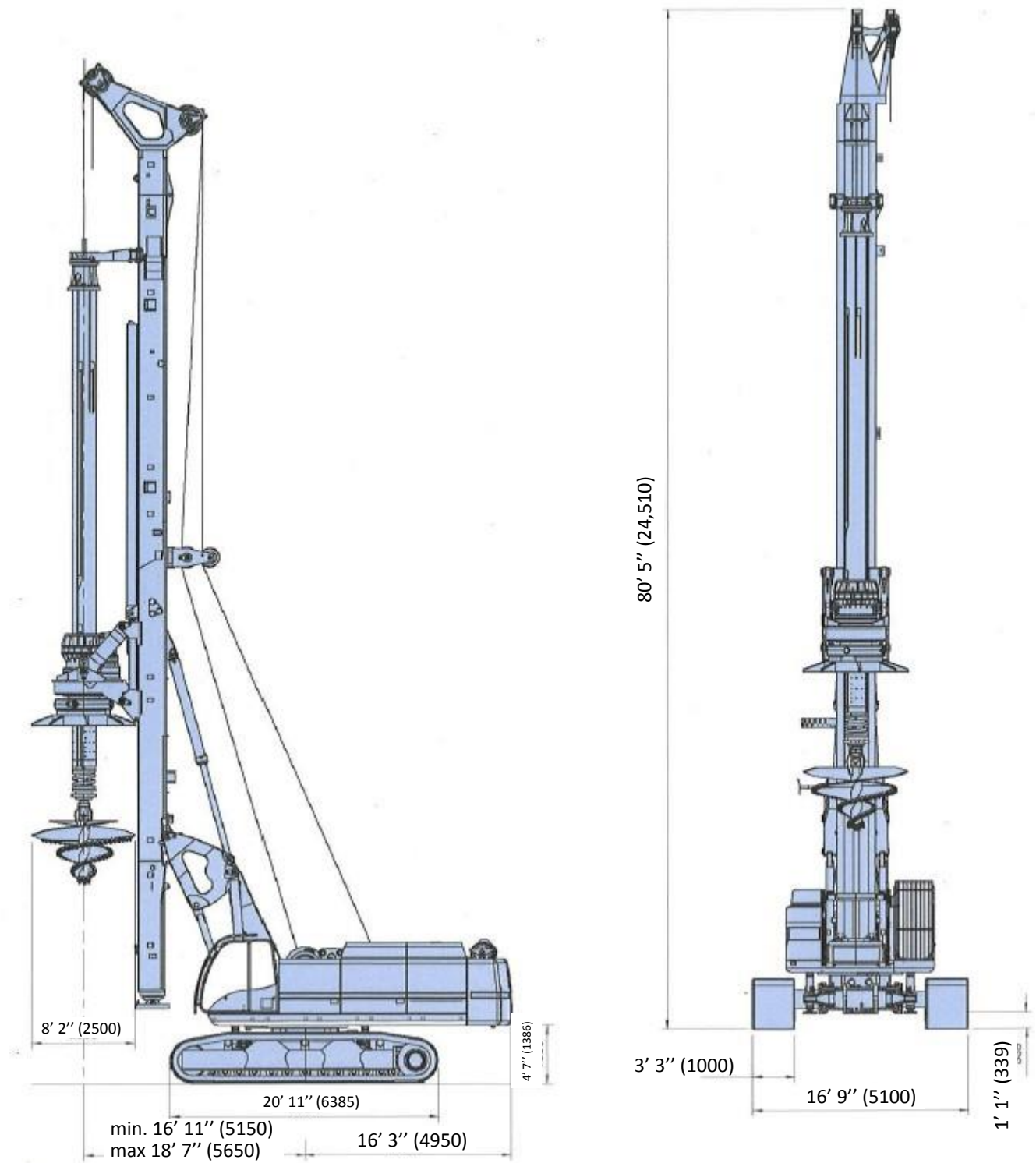

Transport Condition

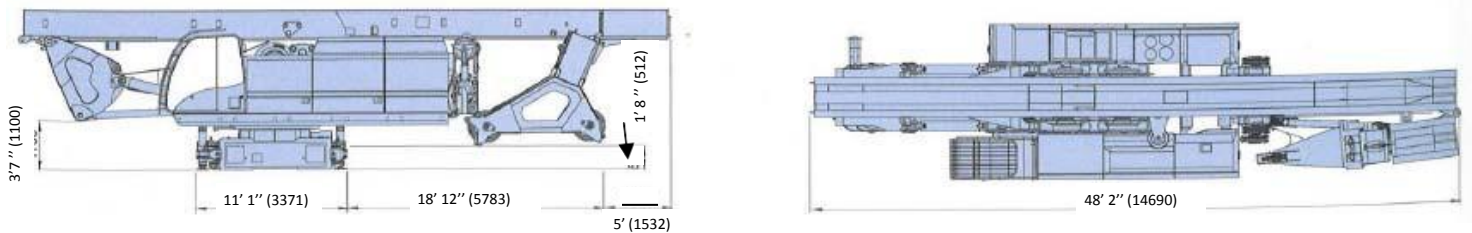

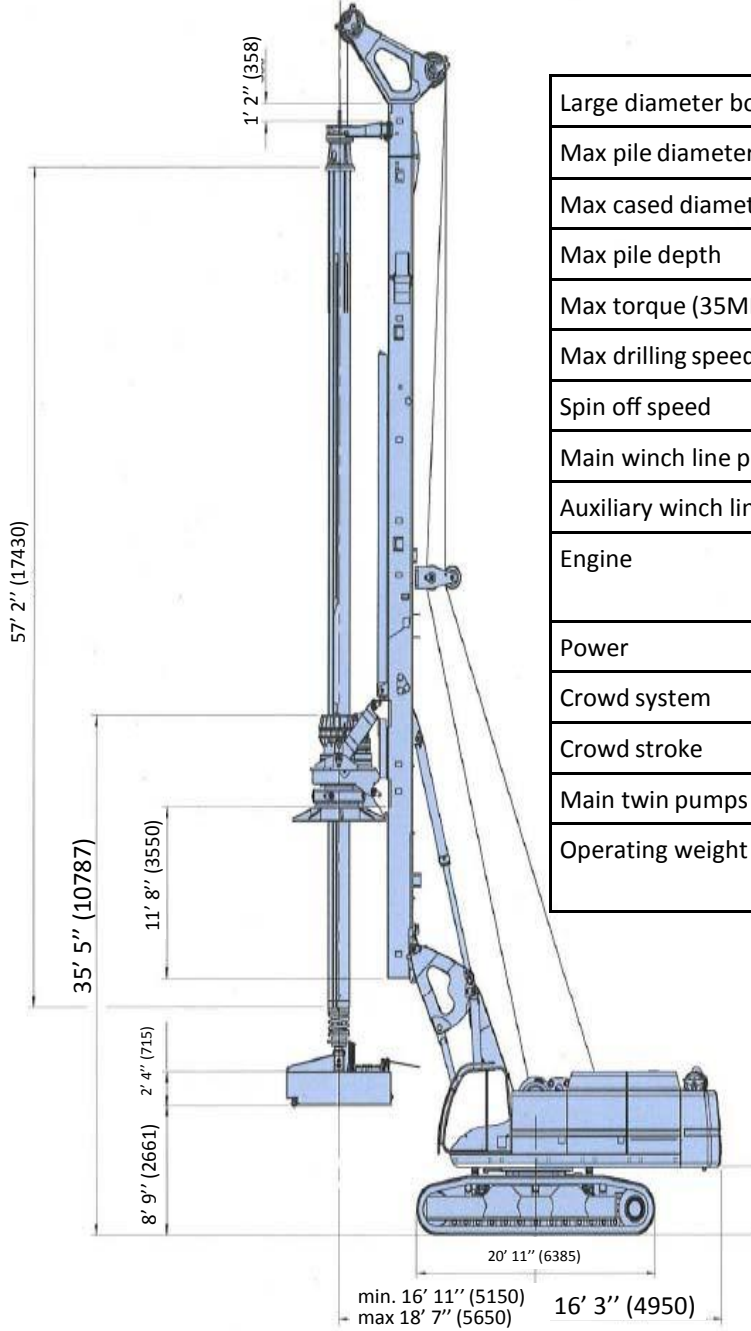

Large diameter bored pile		
Max pile diameter	3000mm	118''
Max cased diameter	2500mm	99''
Max pile depth	86m	282'
Max torque (35MPA)	452kNm	
Max drilling speed	17.4rpm	
Spin off speed	72rpm	
Main winch line pull	330kN	74,187lbs
Auxiliary winch line pull	140kN	31,473
Engine	Deutz TVD 2015V08	
Power	480kW @1900rpm	643BHP
Crowd system	200/420kN	
Crowd stroke	6500mm	256''
Main twin pumps	2x405 l/min	
Operating weight (w/o Kelly -w/o tools)	125tons	

MACHINE IN TRANSPORT CONFIGURATION

KELLY - CFA VERSION

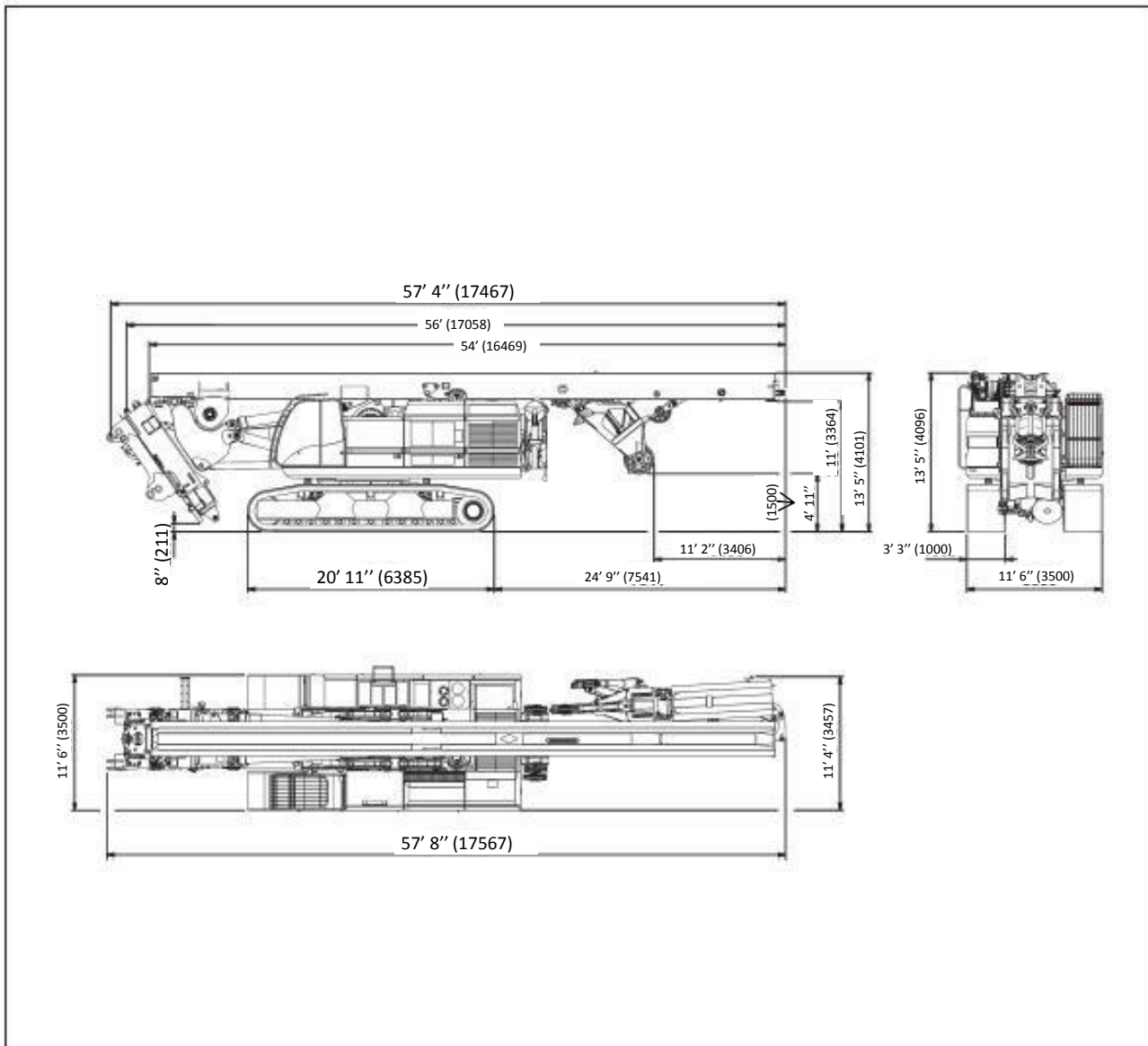

Weight in transport configuration = ~ 223,107lbs (101,200kg)

IMPORTANT
 The transport configuration of the machine can vary in relation to the type of transporting vehicle used (dimensions and weight) and the components that remain installed on the same machine.

IMPORTANT
 If the machine must be transported in a configuration other than the one shown in the picture, recalculate the weight of the machine on the basis of the weight of each component that can be disassembled from the same using chapter "Main detachable elements" as a reference.

ENGLISH

KELLY VERSION WITHOUT TELESCOPIC FOOT

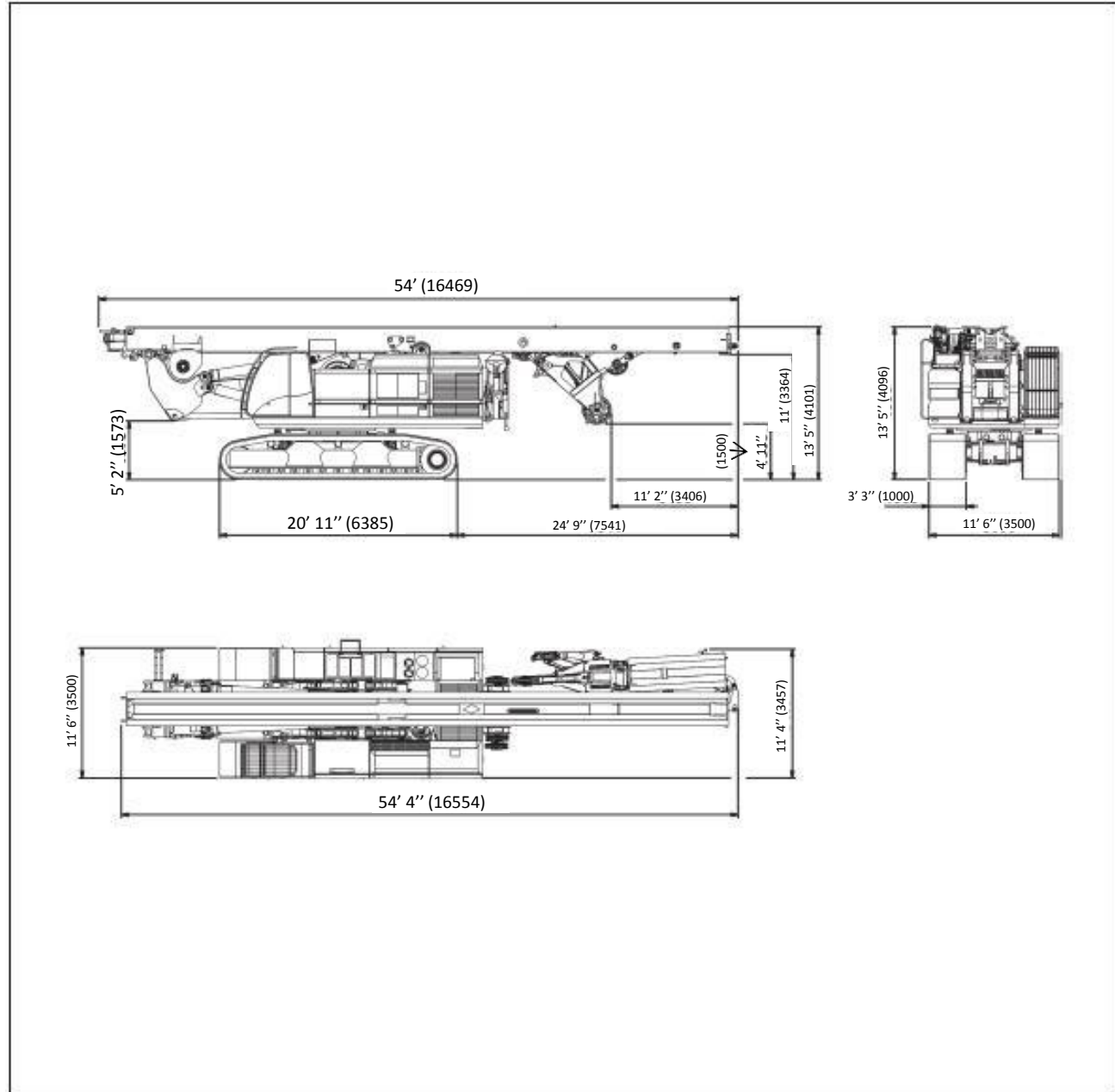

Weight in transport configuration = ~ 215,391lbs (97,700kg)

✓ IMPORTANT
The transport configuration of the machine can vary in relation to the type of transporting vehicle used (dimensions and weight) and the components that remain installed on the same machine.

✓ IMPORTANT
If the machine must be transported in a configuration other than the one shown in the picture, recalculate the weight of the machine on the basis of the weight of each component that can be disassembled from the same using chapter "Main detachable elements" as a reference.

GENERAL INFORMATION - PAGE 42
DIMENSIONS AND WEIGHTS



ENGLISH

KELLY - CFA VERSION WITHOUT TRACK ROLLER FRAMES

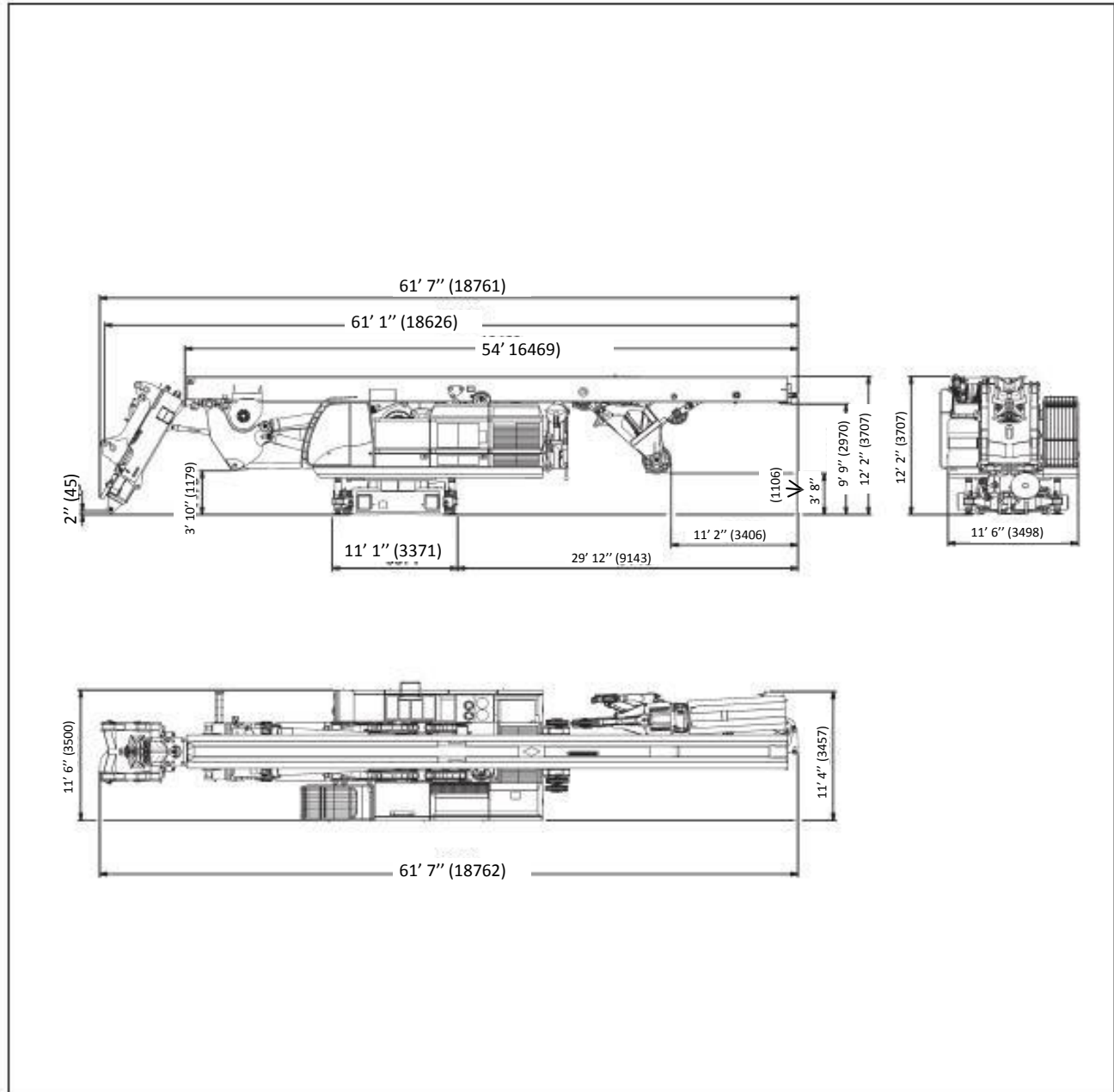

Weight in transport configuration = ~ 176,811lbs (80,200kg)

✓ IMPORTANT

The transport configuration of the machine can vary in relation to the type of transporting vehicle used (dimensions and weight) and the components that remain installed on the same machine.

✓ IMPORTANT

If the machine must be transported in a configuration other than the one shown in the picture, recalculate the weight of the machine on the basis of the weight of each component that can be disassembled from the same using chapter "Main detachable elements" as a reference.

ENGLISH

KELLY VERSION WITHOUT TRACK ROLLER FRAMES AND TELESCOPIC FOOT

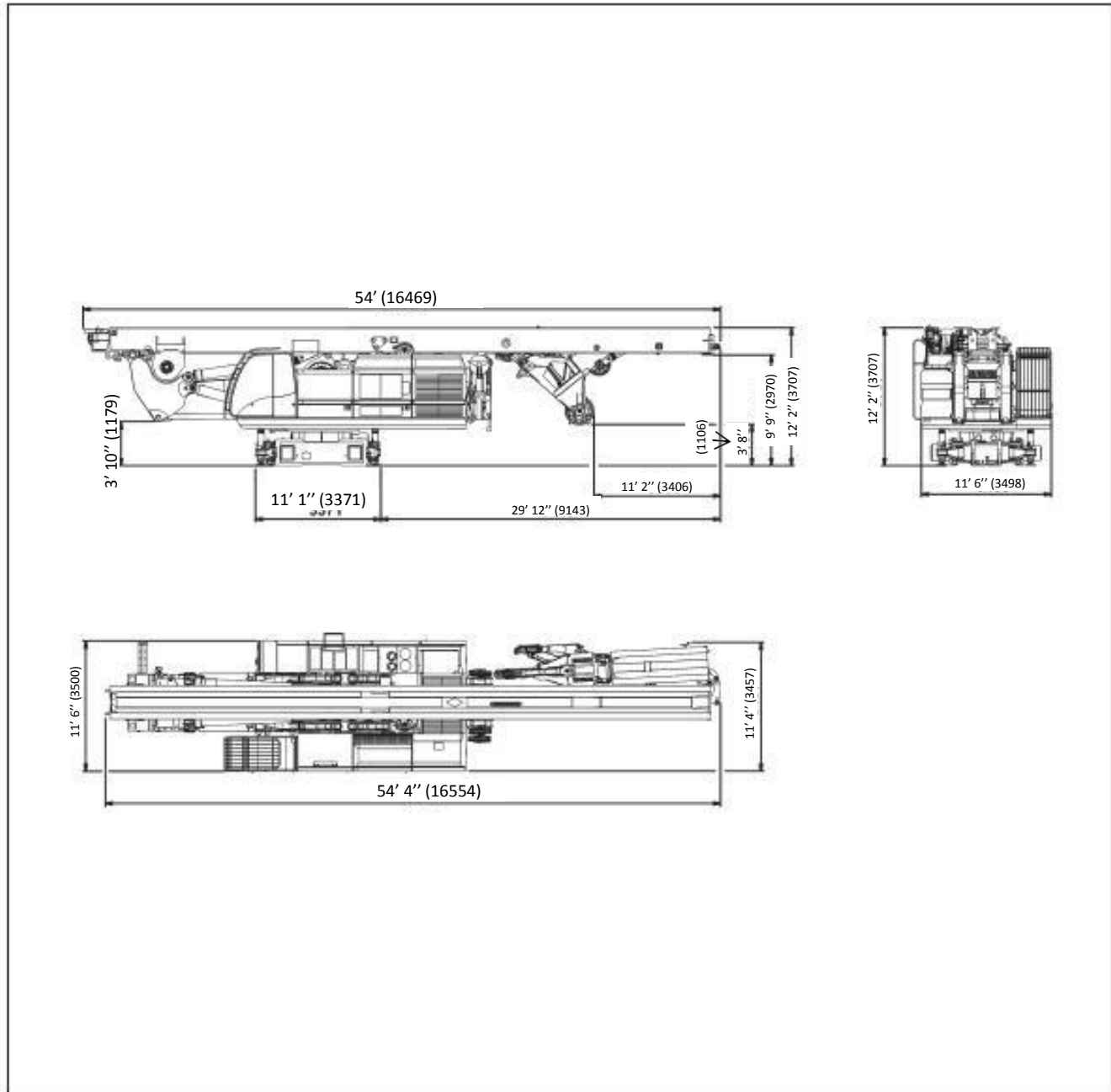

Weight in transport configuration = ~ 169,095lbs (76,700kg)

✓ IMPORTANT
The transport configuration of the machine can vary in relation to the type of transporting vehicle used (dimensions and weight) and the components that remain installed on the same machine.

✓ IMPORTANT
If the machine must be transported in a configuration other than the one shown in the picture, recalculate the weight of the machine on the basis of the weight of each component that can be disassembled from the same using chapter "Main detachable elements" as a reference.

GENERAL INFORMATION - PAGE 44
DIMENSIONS AND WEIGHTS



ENGLISH

MAIN DETACHABLE ELEMENTS

ELEMENTS COMMON TO BOTH VERSIONS

Counterweight 11' 6" x 3' 6" x 5' 2"

Dimensions (L x W x H) = 3500 x 1055 x 1585 mm

Weight = **20000 kg** (including 2 auxiliary removable counterweights weighing 8000 kg)

44,092lbs (including 2 auxiliary removable Counterweights weighing 17,637lbs)



Complete rotary table

Dimensions (L x W x H) = 2450 x 2150 x 2290 mm

Weight = **12260 kg** 8' x 7' 1" x 7' 6"

27,029lbs



Cathead

Dimensions (L x W x H) = 3440 x 2620 x 1200 mm

Weight = **3100 kg** 11' 3" x 8' 7" x 3' 11"

6,834lbs

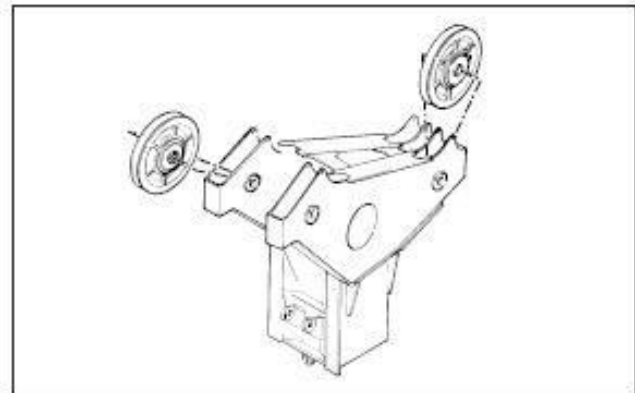

Mast upper element

Dimensions (L x W x H) = 2770 x 1100 x 860 mm

Weight = **1600 kg** 9' 1" x 3' 7" x 2' 10"

3527lbs



ENGLISH

Mast lower element

Dimensions (L x W x H) = 2840 x 1040 x 850 mm

Weight = 1750 kg

9' 4" x 3' 5" x 2' 9"

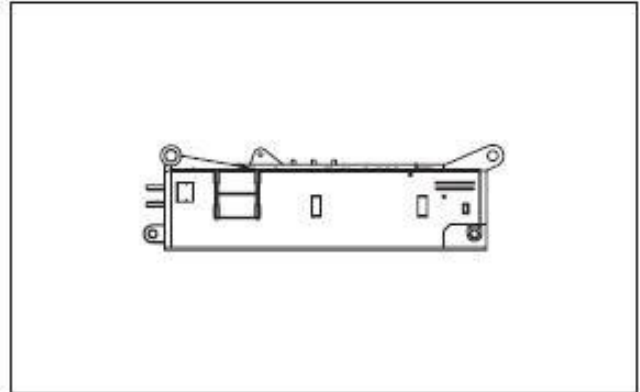
3,748lbs

Service ladder

Weight = 40 kg

88lbs

Track roller frame

Dimensions (L x W x H) = 6368 x 1000 x 1210 mm

Weight = 11000 kg

20' 11" x 3' 3" x 4'

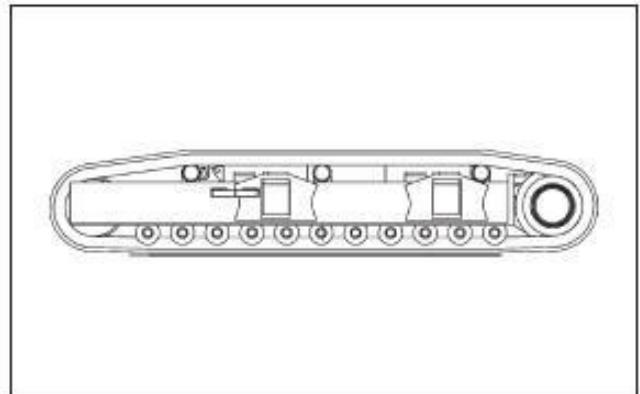
24,251lbs

Pull-down winch complete with support

Dimensions (L x W x H) = 1635 x 890 x 850 mm

Weight = 1200 kg

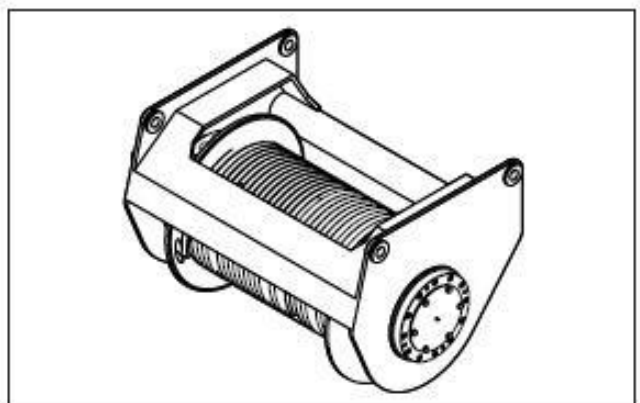
5' 4" x 2' 11" x 2' 9"

2,646lbs

GENERAL INFORMATION - PAGE 46
DIMENSIONS AND WEIGHTS



ENGLISH

Lower rope tensioning cylinder

Dimensions (L x W x H) = 992 x 170 x 170 mm

Weight = 79 kg 3' 3" x 7" x 7"

174lbs

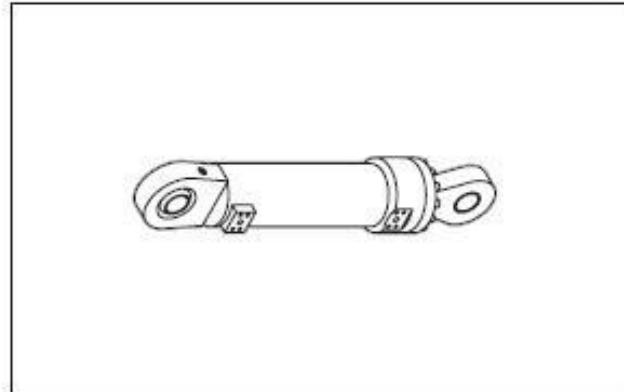

Upper rope tensioning cylinder

Dimensions (L x W x H) = 2452 x 170 x 170 mm

Weight = 180 kg 8' 1" x 7" x 7"

397lbs

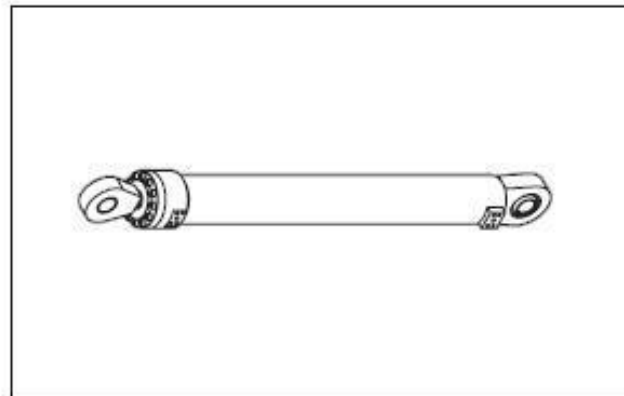

Foot extension cylinder

Dimensions (L x W x H) = 3300 x 290 x 290 mm

Weight = 753 kg 10' 10" x 11" x 11"

1660lbs

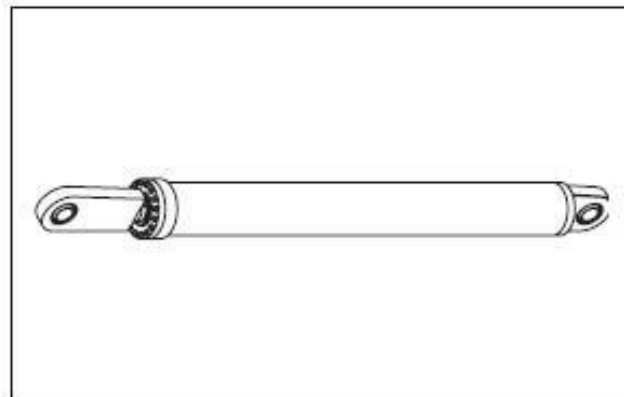

Lower rope tail block (complete with pins and pulleys)

Dimensions (L x W x H) = 1640 x 910 x 850 mm

Weight = 450 kg 5' 5" x 3' x 2' 9"

992lbs

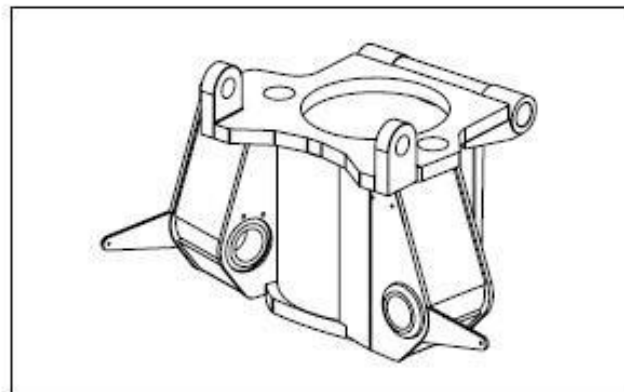

ENGLISH

Telescopic foot supporting base

Dimensions (L x W x H) = 1450 x 1071 x 351 mm

Weight = 522 kg 4' 9" x 3' 6" x 1' 2"

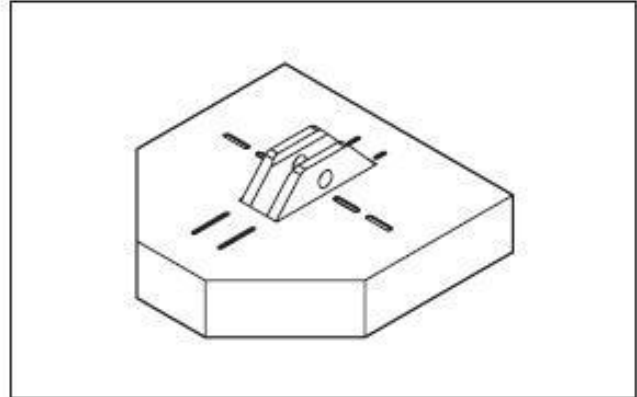
1,151lbs

Telescopic foot

Dimensions (Ø x H) = 470 x 3210 mm

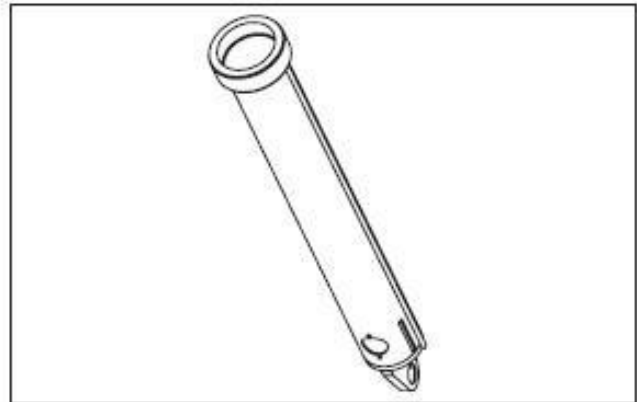
Weight = 518 kg 1' 7" x 10' 6"

1,142lbs

Mast pulley

Dimensions (Ø x W) = 739 x 80 mm

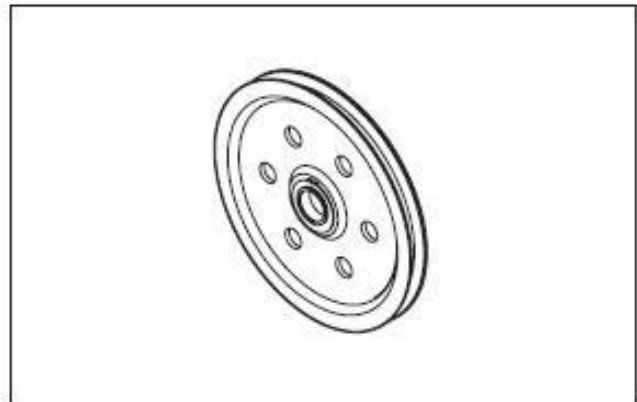
Weight = 72.5 kg each 2' 5" x 3"

160lbs each

Cathead sheaves and pull-down cradle side pulleys

Dimensions (Ø x W) = 583 x 80 mm

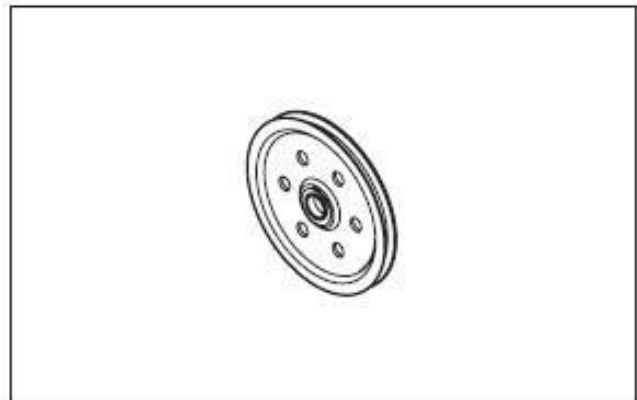
Weight = 49.4 kg each 1' 11" x 3"

109lbs each

GENERAL INFORMATION - PAGE 48
DIMENSIONS AND WEIGHTS



ENGLISH

Pull-down cradle upper pulley

Dimensions (\varnothing x W) = 583 x 95.5 mm

Weight = 53.7 kg each 1' 11" x 3.75"

118lbs each

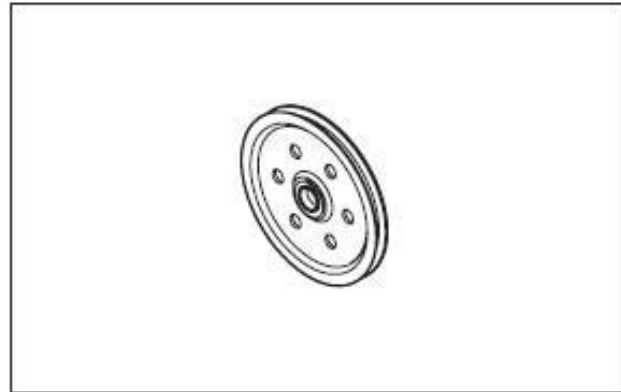

Pull-down cradle lower pulley

Dimensions (\varnothing x W) = 443 x 84 mm

Weight = 32.3 kg each 1' 5" x 3"

71.2lbs each

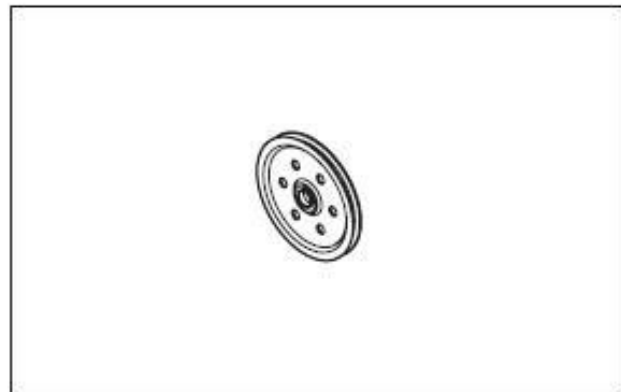

KELLY VERSION

Kelly guide head

Dimensions (L x W x H) = 2020 x 1250 x 1000 mm

Weight = 764 kg 6' 8" x 4' 1" x 3' 3"

1,645lbs

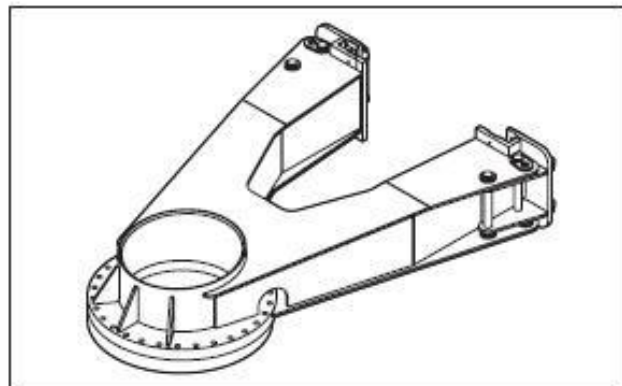

Swivel element

Dimensions (L x W x H) = 127 x 527 x 130 mm

Weight = 35.5 kg 5" x 1' 9" x 5"

78lbs

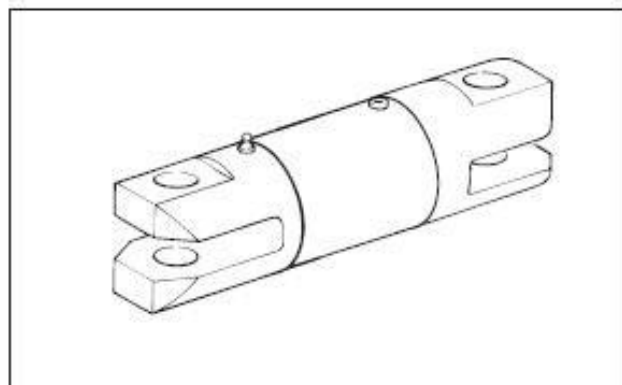

ENGLISH

Bucket striker flange

Dimensions (Ø x H) = 960 x 415 mm

Weight = 150 kg 3' 2" x 1' 4"

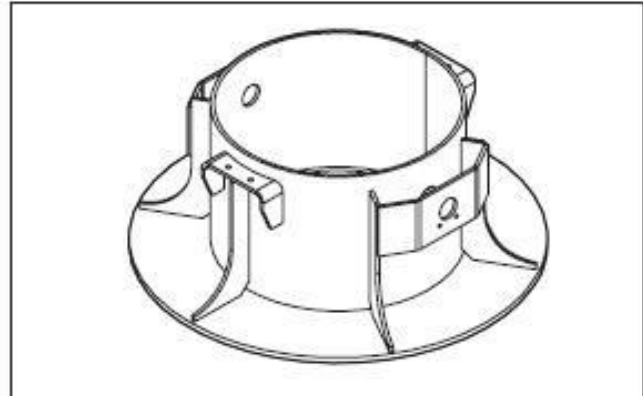
331lbs

Casing driver plate (optional)

Dimensions (Ø x H) = 1500 x 612 mm 4' 11" x 2'

Weight = 848 kg 1870lbs

Dimensions (Ø x H) = 2500 x 612 mm

Weight = 1430 kg 3153lbs 8' 2" x 2'

Dimensions (Ø x H) = 3000 x 607 mm

Weight = n.d. kg

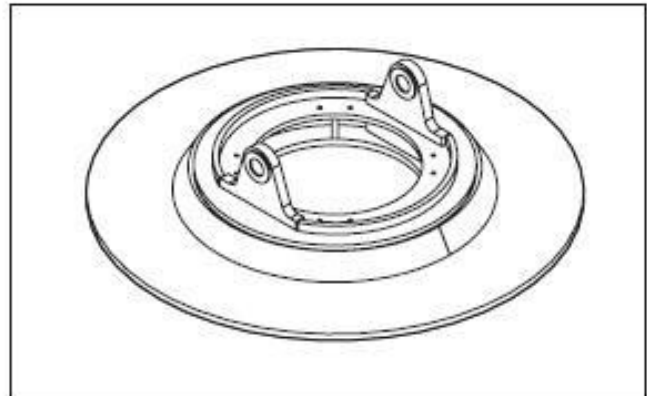
Cardan shaft (optional for casing driver plate)

Dimensions (L x W x H) = 1410 x 1545 x 260 mm

Weight = 682.6 kg 4' 8" x 5' 1" x 10"

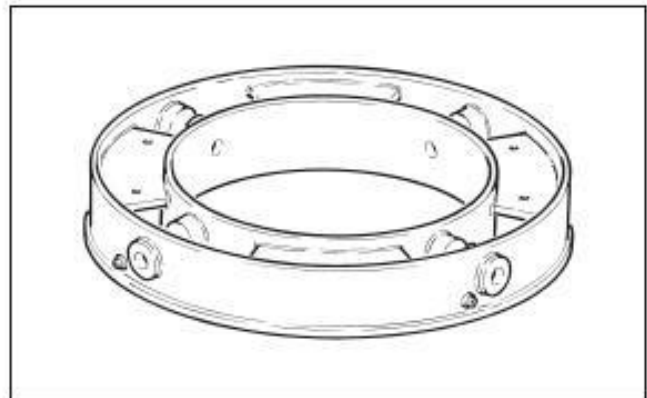
843lbs

Telescopic (kelly) bar

Dimensions = L x 776 x 776 mm 2' 7" x 2' 7"

 IMPORTANT

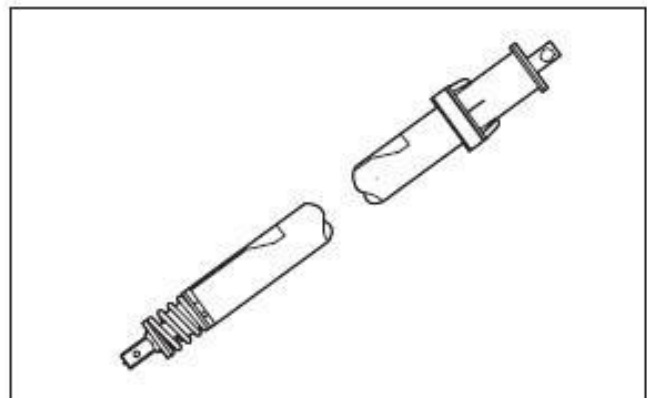
For the length and weight of the telescopic kelly bars, please refer to the relevant paragraph in this section.



GENERAL INFORMATION - PAGE 50
DIMENSIONS AND WEIGHTS



ENGLISH

CFA VERSION

Rotary block

Dimensions (L x W x H) = 380 x 870 x 1530 mm

Weight = 130 kg each 1' 3" x 2' 10" x 5'
287lbs

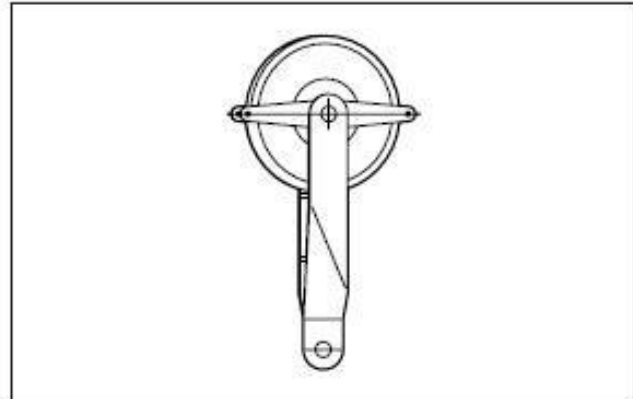

Auger extension guide pole support

Dimensions (L x W x H) = 1095 x 460 x 1030 mm

Weight = 86 kg 3' 7" x 1' 6" x 3' 5"
190lbs

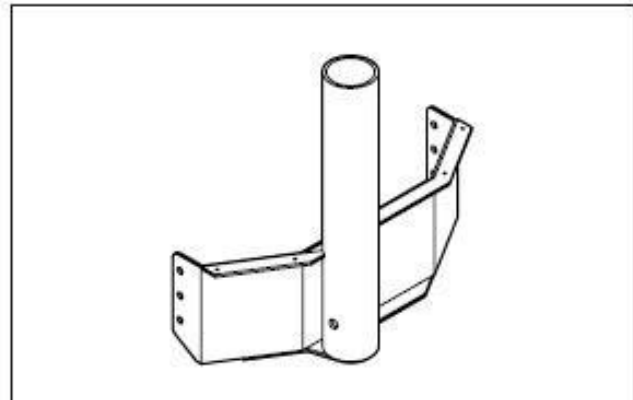

Auger extension guide pole

Dimensions (L x W x H) = 590 x 590 x 930 mm

Weight = 297 kg 1' 11" x 1' 11" x 3' 1"
655lbs

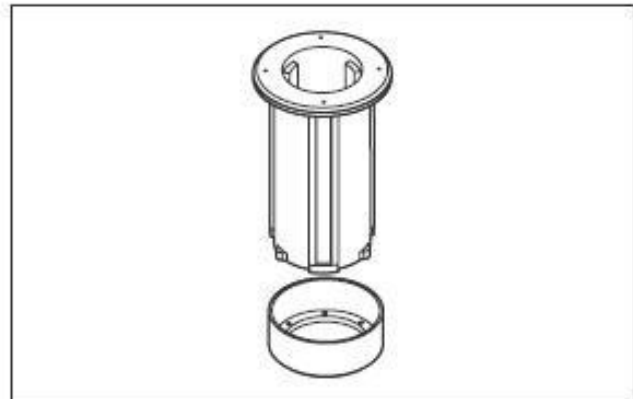

Hydraulic auger guide

Dimensions (L x W x H) = 1780 x 1950 x 1060 mm

Weight = 920 kg 5' 10" x 6' 5" x 3' 6"
2028lbs

