

**REVERSIBLE VIBRATORY PLATES
BPR 70/70 D, BPR 100/80 D**

PERFORMANCE DATA



Machine type	Compaction output (m3/h) at recommended soil layer thicknesses			
	Rock fill	Gravel, sand	Mixed soil	Silt, clay
BPR 70/70 D	39-52	50-66	39-52	33-44
BPR 100/80 D	70-110	90-120	60-90	25-40

Technical Data

Shipping dimensions in m3

BPR 70/70 D	1,133
BPR 100/80 D	1,376

Standard Equipment

- Engine protection hood
- Electric starter
- Tip-Control
- Back-up drive protection
- Low vibration steering rod
- Height adjustable steering rod
- Steering rod lockable in transport and working position
- Vibration and throttle regulation on the steering rod
- Highly wear resistant base plate
- Automatic shutdown at low oil level
- Multi-functional, foldable single-point lifting facility
- Extension plates (700mm) (BPR70/70D)
- Extension plates (800mm) (BPR100/80D)
- 3-2-1 Warranty
- Hour meter

Optional Equipment

- ECONOMIZER (+5kg)
- Tool kit
- Special painting
- Plastic mat
- Extension plates (850mm) (BPR70/70D)
- Extension plates (950mm) (BPR100/80D)
- Service Kit
- Environmentally compliant hydraulic oil
- Safety crank-handle for emergency starting (+3kg)

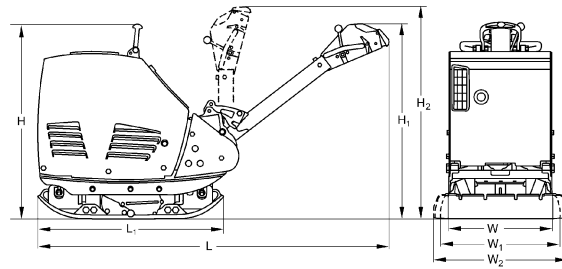

Dimensions in mm

	H	H1	H2	L	L1	W	W1	W2
BPR 70/70 D	870	1030	1470	1860	980	550	700	850
BPR 100/80 D	910	1080	1470	1890	980	650	800	950

Technical Data

Weights

Operating weight CECE (W)	kg	556	689
Operating weight CECE (W1)	kg	579	712
Operating weight CECE (W2)	kg	595	728
Basic weight	kg	570	707

Dimensions

Basic working width	mm	700	800
Working width without extension bars (W)	mm	550	650
Lowest passing height	mm	870	910
Min. height w. steering in top position	mm	1.030	1.080
Max. height w. steering in top position	mm	1.180	1.180

Driving Characteristics

Working speed, max.	m/min	28	28
Max. gradeability (depending on soil con)	%	35	35

Drive

Engine manufacturer		Hatz	Hatz
Type		1D 81	1D 90
Emission stage		4	4
Cooling		air	air
Number of cylinders		1	1
Performance ISO 9249	kW	9,8	11,0
Speed	min-1	2.700	2.600
Drive system		mech.	mech.
Fuel		diesel	diesel

Exciter system

Frequency	Hz	68	56
Centrifugal force	kN	70	100
Amplitude	mm	1,80	2,70

Capacities

Fuel	l	10,0	10,0
------	---	------	------

Technical modifications reserved. Machines may be shown with options.



PRE 692 63 001

080313 Sa

BOMAG
Hellerwald
D-56154 Boppard
P.O. Box 5162
Tel. (0)6742 - 1000
Fax (0)6742 - 3090

